

PVW-B30S

PVW-B

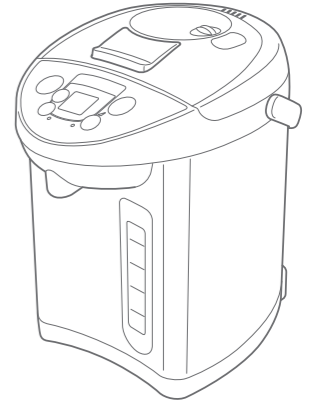

For household use

Vacuum Electric water heater/dispenser

User Manual

Thank you for purchasing this product.
Read all the information in this user manual before using the appliance.
Keep this manual in a handy location for future reference.

家庭用

虎牌VE真空保溫電氣熱水瓶

使用說明書

感謝您購買本公司產品。
請您在使用前，務必詳讀使用說明書，以便正確使用。
並請妥善保管本說明書。

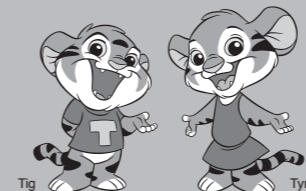

IMPORTANT SAFEGUARDS

When using electrical appliances, basic safety precautions should always be followed including the following:

1. Read all instructions.
2. Do not touch hot surfaces. Use handles or knobs.
3. To protect against electrical shock, do not immerse cord or plug in water or other liquid.
4. Close supervision is necessary when any appliance is used by or near children.
5. Unplug from outlet when not in use and before cleaning. Allow to cool before putting on or taking off parts.
6. Do not operate any appliance with a damaged cord or plug or after the appliance malfunctions or has been damaged in any manner. Return appliance to the nearest authorized service facility for examination, repair, or adjustment.
7. The use of accessory attachments not recommended by the appliance manufacturer may cause injuries.
8. Do not use outdoors.
9. Do not let cord hang over edge of table or counter, or touch hot surfaces.
10. Do not place the water heater on or near a hot gas or electric burner, or in a heated oven.
11. Extreme caution must be used when moving an appliance containing hot oil or other hot liquids.
12. Always attach plug to the water heater first, then plug cord into the wall outlet.
To disconnect, turn any control to "off", then remove plug from wall outlet.
13. Do not use the water heater for other than intended use.

SAVE THESE INSTRUCTIONS

Servicing should be performed by an authorized service representative.
This water heater is intended for household use.

A short power supply cord is provided to reduce the risk of becoming entangled in or tripping over a longer cord. Longer detachable power supply cords or extension cords are available and may be used if care is exercised in their use. If longer detachable power supply cords or extension cords are to be used: (1) the marked electrical rating of the extension cord should be at least as great as the electrical rating of the appliance; (2) if the appliance is the grounded type, the extension cord should be a grounding-type 3-wire cord; and (3) the cord should be arranged so that it will not drape over the countertop or tabletop where it can be pulled down by children or tripped over accidentally.

The following instructions are applicable to 120V only:

This appliance has a polarized plug (one blade is wider than the other). To reduce the risk of electrical shock, this plug is intended to fit into a polarized outlet in only one way. If the plug does not fit fully into the outlet, reverse the plug. If it still does not fit, contact a qualified electrician. Do not attempt to defeat this safety feature.

The appliance is not intended for use by young children or disabled persons without supervision. Ensure that young children do not play with the water heater.

English

Contents

1 Safety Instructions	3~6
2 Parts and Features	7
3 Boiling Water	8~10
4 Dispensing Hot Water	10~11
5 How to use Energy Saving Mode	12
6 Using the Power-Saving Timer	13
7 After Finishing Using the Heater	13
8 Cleaning	14~15
9 Troubleshooting	16~17
Display Messages	17
Specifications	17
Where to buy replacement parts and accessories	18

中文

目錄

1 安全注意事項	19~22
2 各部的名稱與功能	23
3 煮水的方法	24~26
4 取用熱水的方法	26~27
5 節能功能模式的使用方法	28
6 節電定時的用法	29
7 用完後	29
8 保養方法	30~31
9 懷疑是故障時	32~33
有下列情形時	33
規格	33
關於消耗品·耗材洽購	34

CONVENIENT FUNCTIONS

ENERGY SAVING VE

Boils by electricity and keeps warm with thermos flask.

The energy saving VE features an economical "Keep-hot system" combining a vacuum double pot and electric heat.

* "VE" is short for "Vacuum" and "Electric".

Two additional Energy Saving Modes are available.

VE Mode

- Once the water is boiled, heater shutoff automatically and uses Stainless Steel Vacuum Insulation to keep warm.

Energy Saving Mode

- When temperature reaches 98°C, automatically heater shutoff and reduces boiling time.
- Energy Saving Mode cycle applies after 2 hours not in use. Reduce 5°C than regular setting temperature.

節能VE

用「電氣」煮沸再用「真空」保溫

VE節能保溫為電氣保溫加上雙層高真空瓶保溫結構併用的省電保溫模式。

※VE為Vacuum(真空)+Electric(電氣)的簡稱。

設有2種高節能效果的保溫模式。

真空保溫

- 當沸騰後電熱器將自動關閉，透過雙層不銹鋼真空的魔法瓶(保溫瓶)結構進行保溫。

節能功能

- 沸騰前約98°C時電熱器將自動關閉，縮短沸騰的時間。
- 在保溫的情況之下，若2小時以上沒有使用時，設定溫度會降約5°C後持續保溫。

1 Safety Instructions

Read carefully before using and be sure to follow the instructions.

- ※ Be sure to read and observe the safety instructions shown below in order to prevent you and other people from being injured.
- ※ Do not remove caution sticker from the product.

This Manual uses the following two types of symbols to indicate the degree of damage and/or harm caused by misuse of this product.

Warning Indicates the risk of death or serious injury*¹ if the instructions are ignored or the product is used improperly.

Caution Indicates the risk of slight injury*² or physical damage*³ if the instructions are ignored or the product is used improperly.

*¹ Serious injury: blind, scald, electrocute, broken bones, toxicity, and require chronic treatment.
 *² Slight injury: Acute treatment, burn and electric shock.
 *³ Physical damage: loss of household property and pets.

Symbol Figuration

Caution △ indicates warning and caution. It explains in picture sign and outline.

Prohibition ⊘ Indicates prohibition. It explains in picture sign and outline.

Direction ● Indicates operating direction. It explains in picture sign and outline.

Extra attention must be paid when used in a household where infants or toddlers are present.

Warning

Do not allow children to use the appliance by themselves, and do not use in areas within the reach of infants or toddlers, this is to avoid scalds, electric shock, or injuries.

This appliance is not intended for use by persons (including children) with physical difficulties or lack of experience and knowledge - unless they have been given supervision or instruction concerning the use of the appliance by a person responsible for his/her safety.

To avoid scalds, do not touch or allow your face to get close to the steam vent.
Especially keep out of the reach of infants and toddlers.

Do not allow infants or toddlers to lick the appliance plug.
Extra attention must be paid to avoid electric shock or injuries.

Close the lid tightly until a "clicking" sound is heard.
Failure to do so may inhibit boiling or cause scalds if the heater were to fall or spill hot water.

Caution

Do not use on an unstable surface, especially on a table or rug that is vulnerable to heat.
Failure to do so may cause a fire, or scalds if the heater falls and spills hot water, or a color change / deformation on the table or rug.

Warning

- Do not modify. Do not allow anyone other than a repair technician to disassemble or repair the appliance, this is to avoid fire, electric shock, or injuries.**

Use the product at local Voltage only.
Using the product at any other voltage may result in fire or electric shock.

Use an AC outlet of 7A or higher rating exclusively for the product with 220V or higher.
Connecting other instruments with the same AC outlet may cause the branch socket to overheat, resulting in fire.

Do not use a damaged power cord, and do not damage the power cord.
(Protect the power cord, do not use force, place near a high humidity area, pull, twist, bundle, place something heavy on top, or tuck.) Failure to do so may cause fire or electric shock.

If dust collects on the outlet, completely wipe off the dust, this is to avoid fire.

Firmly insert the plug into the outlet to avoid electric shock, shorting, smoke, or fire.

Do not use the heater if the power cord or plug is damaged or the plug in the outlet is loose, this is to avoid electric shock, shorting, or fire.

Do not plug in or unplug with wet hands, this is to avoid electric shock or injury.
Do not touch the unit with wet hand.

Do not exceed the full water level mark, this is to avoid scalds due to hot water spillage.
If the water is lower than the refill mark, discoloration of the container or other problems may occur.

Do not close the lid using excessive force, this is to avoid scalds due to hot water spillage.

Do not block the steam vent with a cleaning cloth or other items, this is to avoid scalds due to hot water spillage or deformation of the lid.

Do not boil anything other than water.
Pouring tea, milk, sake, tea bags, tea leaves, or instant food into the heater may form bubbles and cause scalds due to hot liquid spillage. This may also cause scalds, corrosion, or peeling of the fluoropolymer-coated surface.

Do not use as an ice cooler.
Cold water or ice may cause dew condensation, electric shock, or other problems.

Warning



Do not hold tight, tilt, rock, shake up and down vigorously, or jolt. Do not carry by holding the lid.

Do not tilt or tip even if it is "locked," this is to avoid scalds due to hot water spillage.



Do not tip the heater over.

Do not tilt or tip even if it is "locked", this is to avoid scalds due to hot water spillage.



Do not soak the unit in water or pour water on the unit, this is to avoid shorting, electric shock, or fire.

Never immerse the unit in water or other liquid.



Do not discard remaining hot water with the lid closed, this is to avoid scalds due to hot water spillage if the lid were to come off.

(Refer to p.6,13 on how to discard remaining water)



When lid gaskets become white, replace the gaskets with new one.

Scaling may occur if the unit falls and leak.



Stop using the product immediately following conditions:

- Power cord or unplug become extremely hot.
- Power is not conducted properly when power cord is shifted from different position.
- It starts to smell burnt.
- Water leak from the unit.

Ignoring the malfunction symptoms cause personal injury, break out fire, electric shock.

Contact customer service at once.

Caution



Leave unplugged when not in use, this is to avoid injury, scalds, electric shock, or fire caused by a short-circuit.

Unplug the power cord.



Be sure to firmly hold the plug when removing from an outlet, this is to avoid electric shock, shorting, or fire.



Do not use a power cord other than the designated cord for this product.

Do not use a power cord from another appliance, this is to avoid problems or fire.



Do not use multiple outlet receptacles, this is to avoid fire.



Do not use or place in areas prone to getting wet and do not allow the bottom of the heater to get wet, this is to avoid shorting, electric shock, or malfunction.



Do not fill with water directly from the faucet.

Water may get into the unit and cause shorting, electric shock, or malfunction.



Do not use near the wall or furniture.

Steam or heat may damage the walls or furniture and cause discoloration or deformation.

If using a kitchen storage rack, be sure that the steam does not stay inside.

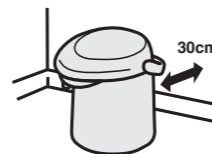

Do not come in contact with steam or condensation when opening or removing the lid, this is to avoid scalds.

Do not touch or contact

Caution



Do not dispense hot water while the water is being boiled.

Hot water may splash and cause scalds.



Do not turn on the heater while dispensing hot water.

Hot water may splash and cause scalds.



Do not touch the hot surface while in use, allow to cool first, this is to avoid scalds.

Do not touch or contact



When carrying the unit, do not touch the close/open lever of the lid.

The lid may open and cause injuries or scalds.



Cleaning can only be done after the unit has cooled down, this is to avoid scalds caused by touching a hot surface.



When cleaning, unplug the AC power cord from the AC outlet first, and then unplug the appliance plug from the water heater's insert slot.

After cleaning, make sure the appliance plug, insert slot for plug, and the plug to the AC outlet are not wet before using. Do not move the water heater while it is switched on.

Caution: It may cause electric shock or fire.



When discarding remaining hot water, be sure to discard in the direction shown in the following illustration.

If the water is discarded from another location, the hot water may get inside the unit and cause malfunction or scalds.

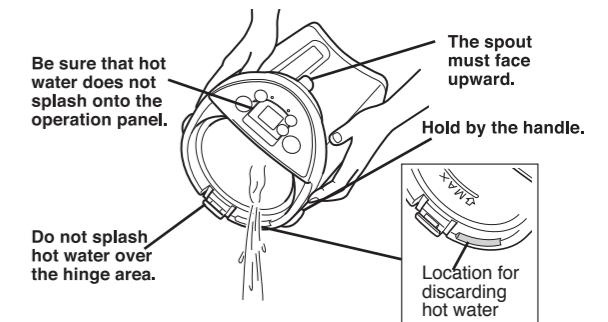

Do not wash the entire unit, or pour water inside the unit or on the bottom of the unit, this is to avoid shorting, electric shock, or malfunction.



Do not place the unit up side down.

Moisture or water drop leak into the unit caused a malfunction.



This appliance is intended to be used in household and similar applications such as:

- staff kitchen areas in shops, offices and other working environments;
- farm houses;
- by clients in hotels, motels and other residential type environments;
- bed and breakfast type environments.

These safety instructions will allow the heater to be used for many years.

Do not use near an open flame, this is to avoid deformation or malfunction.

Do not use in areas exposed to direct sunlight for a prolonged period.

The unit may become hot and malfunction.

Do not turn on the heater without water inside. Turning on the heater without water may cause heat discoloration of the interior of the container or malfunction.

Do not put charcoal such as Bincho charcoal into the container, this is to avoid malfunction or peeling of the fluoropolymer-coated surface.

2 Parts and Features

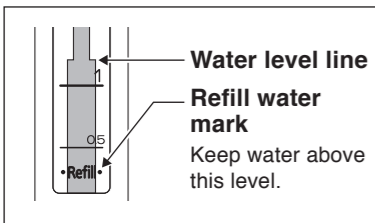
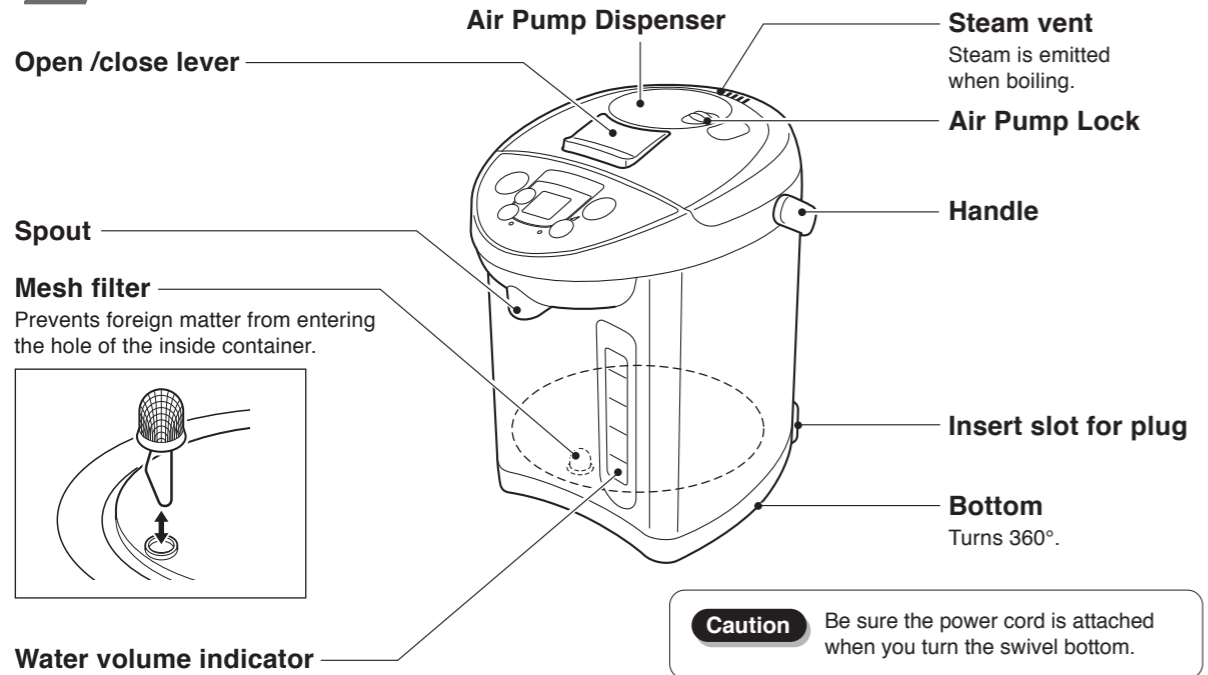

The numbers such as 98, 90, 80 indicated in this instruction manual are only approximate temperatures.

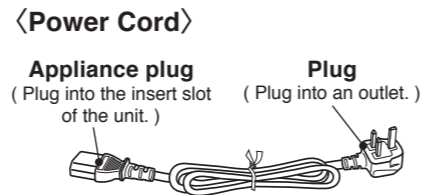
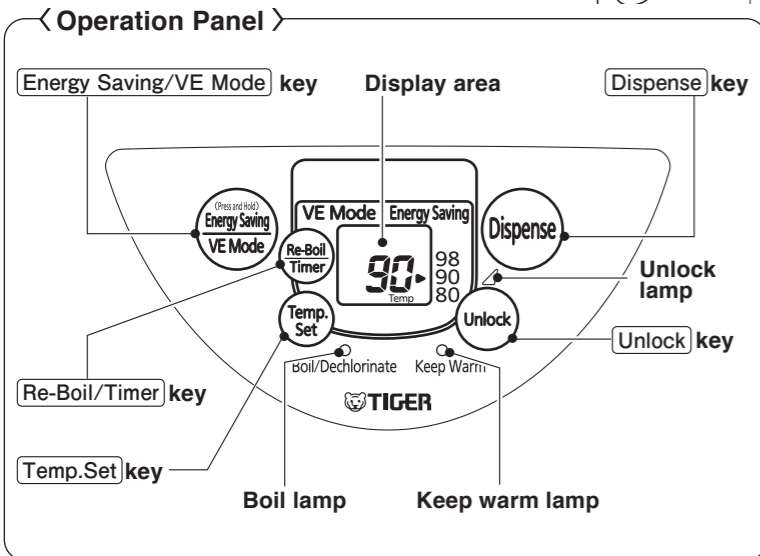

Sounds

When the water is being boiled, bubbling sounds can be heard from inside the container. This is normal and does not indicate a malfunction.

3 Boiling Water

For first use / The unit was not in use for extended time

- Be sure to clean the unit before use. You may smell resin beginning of the usage. Smell start to diminish in time.
1. Add water to full water level and then bring up to boil. (See below)
 2. After water is boiled, use electric dispenser button to discard half of hot water. (See p.10)
 3. Unplug the power cord, open the lid and then discard the rest of hot water. (See p.13)

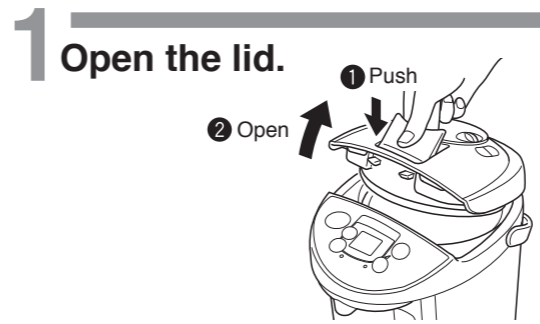

Sound You may hear rattle sound when opening /closing the lid. There is a valve in the outer lid for prevention of water spillage.

2 Pour water into the unit with a separate container.

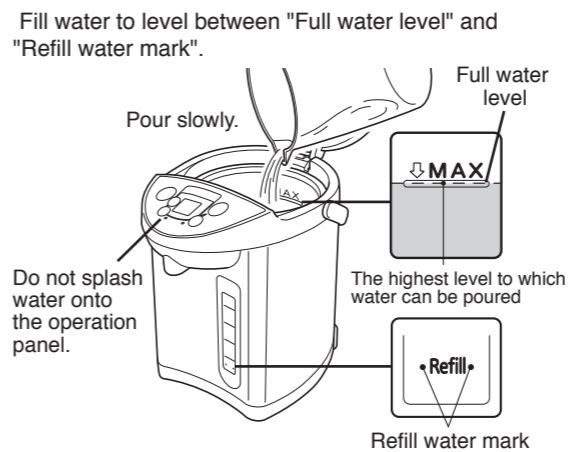

Caution

- Do not fill water directly from a faucet. Do not place the unit on wet surface.
- Automatic Boil cycle may not work when refilling hot water above 50°C, be sure to add lukewarm water or cold water or press [Re-Boil/Timer] key. (See p.10)
- Do not exceed "Full water level". Do not boil water if the water level is lower than refill mark.

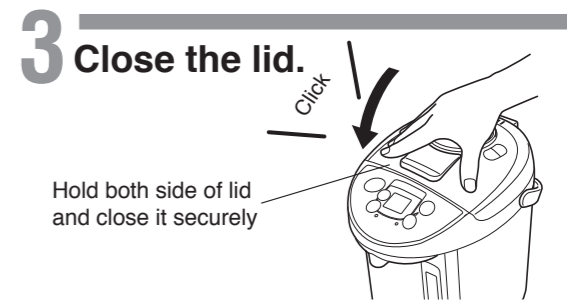

Caution If the lid is not close securely, hot water may spill when it fall and cause scaling.

4 Connect the power cord.

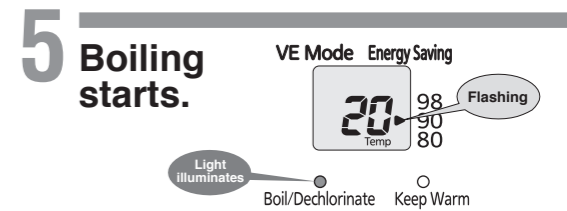
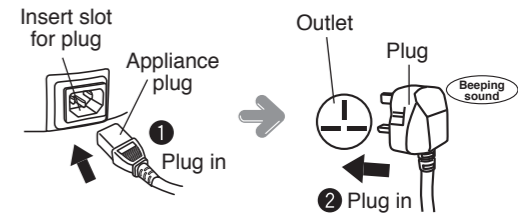

* Refer to p.9 when selecting the temperature for Warmer. (If no selection is made, a temperature of 90°C will be automatically set.)

* Refer to p.13 for setting the power-saving timer.

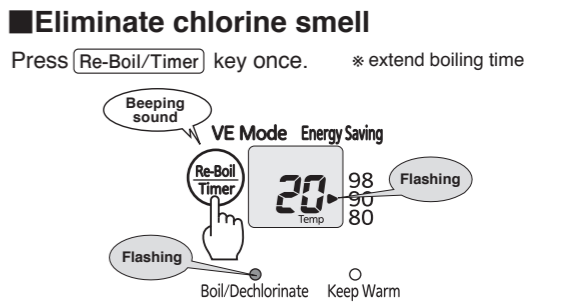

3 Boiling Water

6 Select [Keep Warm]

Press [Temp.Set] key or [Energy Saving/VE Mode] key.

Keep Warm temperature

98(approx.98°C). 90(approx.90°C).
80(approx.80°C)

Each press of [Temp.Set] key changes different temperature setting as shown.

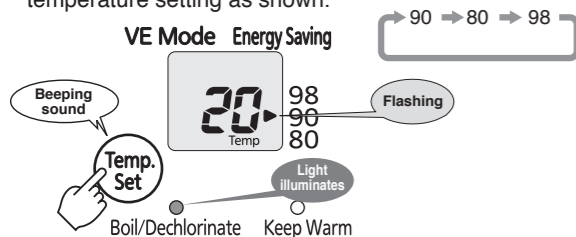

VE Mode

Press [Energy Saving/VE Mode] key. Indicator appears on the display. Press again to cancel [VE Mode]. Indicator disappears.

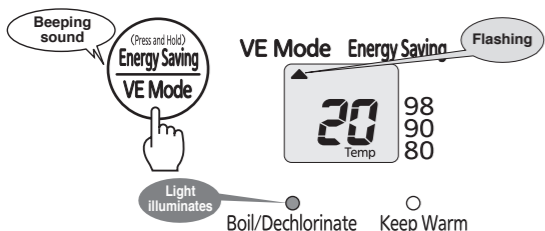

- 4 temperature settings are available. (80, 90, 98 and VE Mode)
- If you select VE Mode cycle, the heater will automatically shut off after boiling cycle is done.
- You may able to change temperature setting during Boiling cycle or Keep Warm.

Caution

- If the power cord comes off during the temperature setting, the setting is not completed. It will go back to default setting. (90)
- Do not press the key firmly for a long time. Energy Saving Mode cycle may apply. (See p.12)

During the boiling cycle

Current water temperature Remaining time until boiling

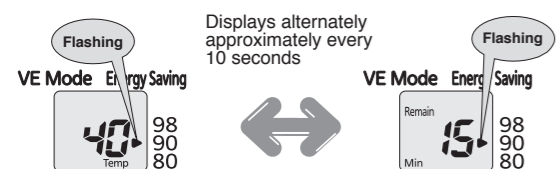

- * Timing to start displaying remaining time will vary depending on the amount of water and the water temperature.
- * Water temperature will be displayed by every 5°C. (If it is approximately 98°C, it will display "98".)

7 Automatically set to warmer

When boiling

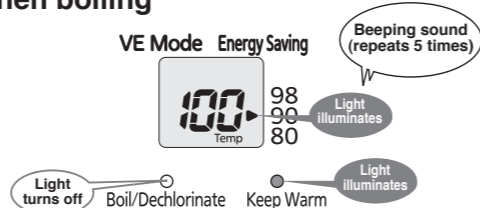

When water temperature reaches setting temperature,

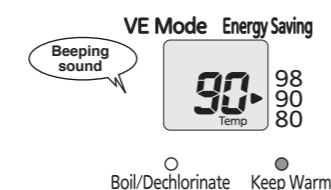

Caution

- Do not come in contact with the steam to avoid being scalded.
- Do not open or close the lid with excessive force and do not dispense hot water during the boiling cycle or immediately after boiling. Failure to do so may cause scalds due to hot water splashing or steam being emitted.

Time table for Boiling and Cooling.

Boiling from cold water	Approx. 31 minutes
From boiling to reach 90 warmer temperature	Approx. 3hour and 45 minutes
From boiling to reach 80 warmer temperature	Approx. 6hour and 50 minutes

* Under these conditions: full water volume, the water temperature / room temperature is 23°C, and voltage is normal rated voltage.
* Guidelines for the time required to reach the 98 warmer temperature are almost the same as those for boiling from cold water.

Temperature retention for energy saving mode.

Water temperature decrease accordingly depending on the amount of water was kept inside.

2 hours elapsed	91°C +
-----------------	--------

* The data above indicates the full water amount and room temperature at 23°C.
* Temperature displays 5°C interval on the panel. Display temperature and actual temperature may not be match.

4 Dispensing Hot Water

How to use Electric Dispenser.

1 Press the [Unlock] key once.

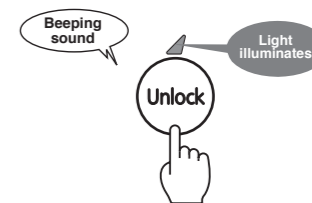

2 Press the [Dispense] key.

Place a container under the spout, and press the [Dispense] key.

Hot water continues to dispense while pressing the key.

- * After checking that hot water has stopped dispensing, remove the container from the spout
- * If the unit is unplugged, hot water cannot be dispensed.
- * When water is boiled air pressure increase in the container so that water dispenser may not produce a smooth water flow immediately after its boiled. Release the air pressure by opening the lid and then dispense the water. Caution for hot steam.
- * Mineral deposit build on the wall of inner container, mesh filter or pump unit, water does not dispense. (Clean the unit with Citric Acid. See p.15)
- * If the [Dispense] key is not pressed for approx. 10 seconds after dispensing hot water, the unlock lamp will be turned off and the unit will lock automatically.

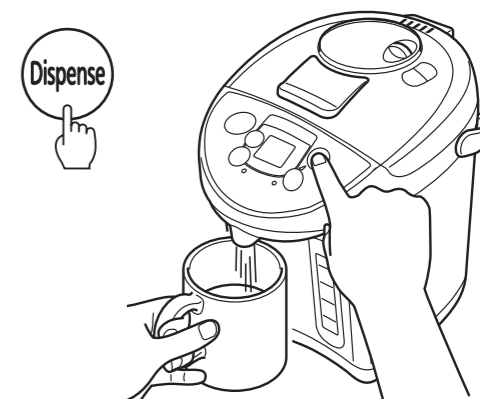

Caution

- Do not dispense when water level is at "Refill water mark". Hot water may splash when you dispense.
- Pay close attention when dispensing hot water so as to not spin the entire unit around.

Re-boil during the Keep Warm cycle. Press [Re-Boil/Timer] key once.

Be sure the water level is above Refill water mark.

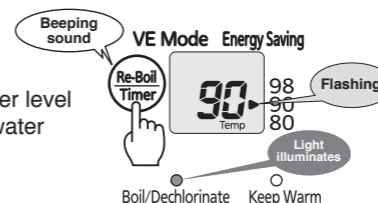

Guidelines for the time required for re-boiling when the water is at the full water level

Warmer temperature at 98, 90	Approx. 4-9 minutes
Warmer temperature at 80	Approx. 9-11minutes

* Adding water or reattaching the power cord during Boiling cycle, boiling time may extend.
* Boiling time may vary during VE Mode cycle.

Reduce chlorine smell during Keep Warm cycle.

Press the [Re-Boil/Timer] key twice.

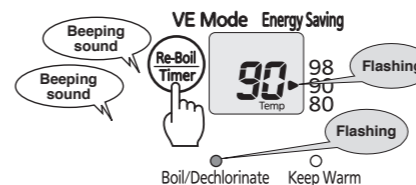

Choose Re-boil/Timer option. Press [Re-Boil/Timer] key and scroll through the option until you reach your preferred option cycle.

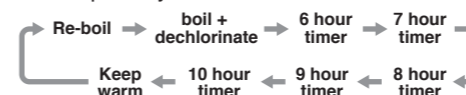

* Be sure to check the display panel for your preferred cycle. It uses both [Re-Boil/Timer] key and [Power-Saving Timer]

4 Dispensing Hot Water

3 Press the **Unlock** key once.

The **Dispense** key will be locked, and hot water cannot be dispensed even if the key is pressed.

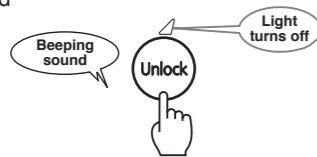

■ Refill water when it becomes low level.

Be sure to refill water before it reaches [Refill water mark], and close the lid securely. (Caution for hot steam when refilling water. See p.8)

- Caution**
- Do not leave the unit without any water inside, this is to avoid malfunction due to boiling without water.
 - Keep warm during VE Mode cycle (power cord is plugged in to wall socket); the unit does not start re-boil automatically when you dispense.

How to use Air Pump Dispenser

You may able to dispense water without the electricity.

1 Turn the Air Pump Lock to **[Unlock]** position.

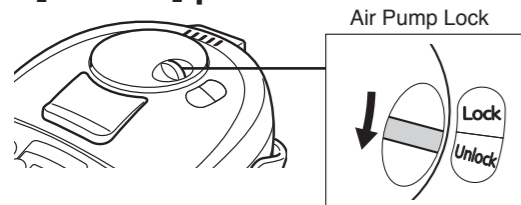

2 Gently press Air Pump Dispenser.

Place the cup/ container under the spout, gently press Air Pump Dispenser.

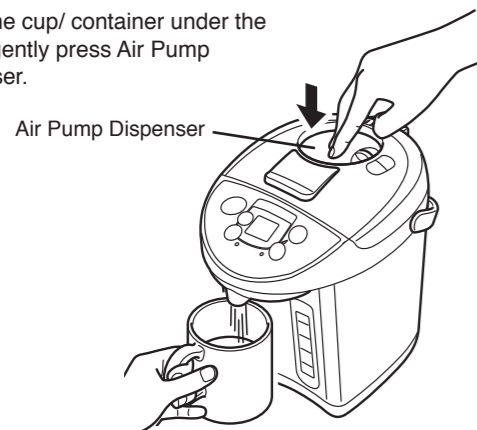

- Remove your fingers away from Air Pump Dispenser, be sure the water is stop dispense and then remove the cup/container
- Air Pump Dispenser does not produce a smooth water flow compare to Electric Dispenser.
- When water temperature decrease or water level is low, Air Pump Dispenser does not produce a smooth water flow.

- Caution**
- Be sure to press Air Pump Dispenser gently. Water may splash or not dispense when pressing the Air Pump Dispenser intensely.
 - Do not dispense when water level is at "Refill water mark", Hot water may splash when you dispense.
 - Pay close attention when dispensing hot water so as to not spin the entire unit around.
 - Do not use both Electric and Air Pump Dispensers at the same time. It may result in malfunction of the unit.

3 Set Air Pump Lock at **[Lock]** position.



Water does not dispense when Air Pump Lock is [Lock] position.

■ Refill water when it becomes low level.

Be sure to refill water before it reaches [Refill water mark], and close the lid securely. (Caution for hot steam when refilling water. See p.8)

- Caution**
- Do not leave the unit without any water inside, this is to avoid malfunction due to boiling without water.
 - Keep warm during VE Mode cycle (power cord is plugged in to wall socket); the unit does not start re-boil automatically when you dispense.

5 How to use Energy Saving Mode

Energy Saving Mode applies to Boiling and Keeps Warm cycles.

- Energy Saving Mode Boiling: heater will shut off when temperature reaches 98°C and reduce boiling steam. (Depending on the room and water temperature, the steam cut function may not work.)
- Energy Saving Mode cycle applies after 2 hours not in use. It reduces approximately 5°C than regular setting temperature e.g.: If you select 98, Energy Saving Mode is 95.

1 Select **[Energy Saving Mode]**

Press and hold **Energy Saving/VE Mode** key for a second.

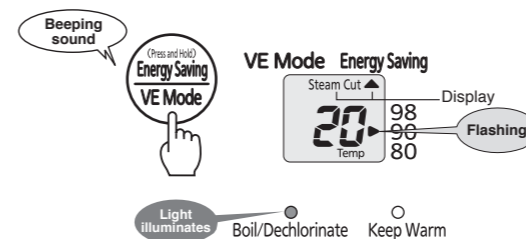

■ Disabling steam cut function for Energy Saving Mode cycle.

Boiling cycle with dechlorinate. (See p.8)

2 Select **[Keep Warm]** (See p.9)

3 Once water reaches boiling point, it automatically switch to **Keep Warm** cycle.

■ When boiling cycle is done;

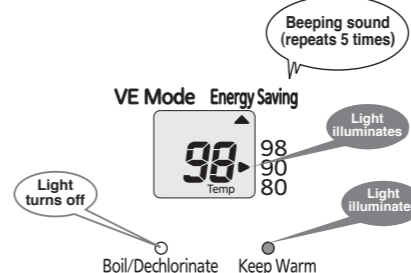

■ Water reaches setting temperature;

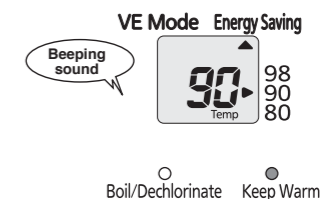

■ If the unit not in use for 2 hours, it will automatically switch to **Energy Saving Mode** cycle. (5°C lower than regular setting temperature)

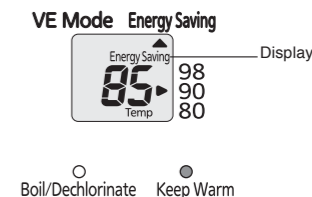

*The heater is off during VE Mode cycle so water temperature will decrease accordingly.

How to bring back to setting temperature.

Press **Temp.Set** or **Unlock** key once. Bring back to setting temperature about a minute.

How to cancel Energy Saving Mode

Press **Energy Saving/VE Mode** key for a second. (It automatically reheats when the temperature is low.)

Sound You may hear buzzing sound when you are selecting Energy Saving Mode cycle, the unit automatically reheats to setting temperature. (See p.16)

Caution Keep your face or other body parts away from the steam vent which may be hot during Energy Saving Mode boiling cycle.

6 Using the Power-Saving Timer

Power-Saving timer can be set in 1 hour intervals from 6 to 10 hours. You may be able to set before go to sleep, or going out; Unit shut off the power during the energy saving timer. When the timer is over, the unit reheats the water automatically.

Press **Re-Boil/Timer** key and select energy saving hours

Be sure to check the status on the display.

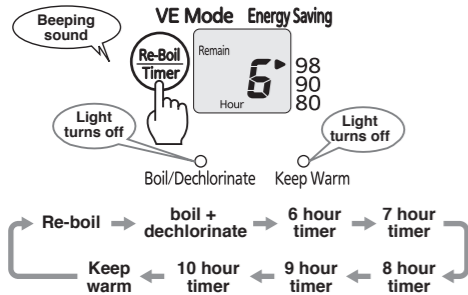

* Remaining time will be displayed on an hourly basis until one hour before the Power-Saving Timer completes the operation

Note:

- The unit will start to boil 1 hour before the completion of the timer; the display will show 59 minutes counting down to 1 minute.
- After boiling, keep warm at setting temperature.

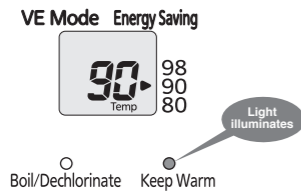

- Caution**
- Electric Dispenser does not work during Power-Saving Timer is on.
 - The heater is off during Power-Saving Timer so water temperature will decrease accordingly.

How to Cancel the Timer

Press the **Re-Boil/Timer** key to turn the Boil lamp on.

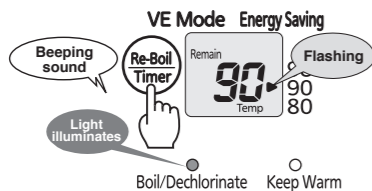

7 After Finishing Using the Heater

1 Unplug

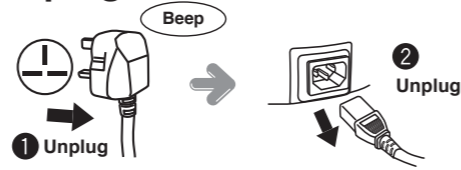

2 Remove the lid

While pressing down on the attach / remove lever for the lid, open and remove the lid by pulling the lid toward the spout.

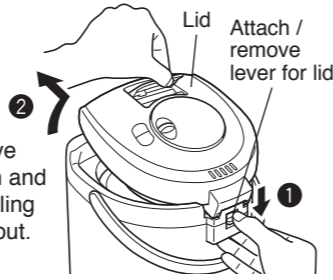

3 Discard remaining hot water (Refer to p.6)

- Caution**
- Move the unit to the kitchen sink and then discard water slowly. Caution for hot water may splash during this operation.
 - Watch out for hot water dripping from the spout immediately after discarding the hot water.
 - Be sure to clean the inner container and mesh filter. (Refer to p.14)

4 Attach the lid.

While pressing down on the attach/remove lever for the lid, insert the hook-on part of the lid.

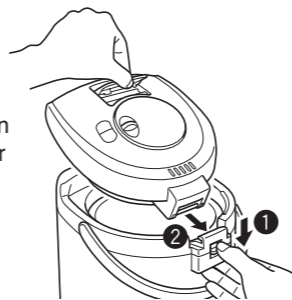

- Caution**
- Do not leave hot water remaining inside the container, this is to avoid discoloration of the inside container or foul odors from forming.
 - Do not turn the spout downward with the lid on, or discard hot water from the hinge area, this is to avoid scalds from splashing hot water or malfunction.
 - Pay extra attention when discarding the remaining hot water, as the mesh filter may fall if it is not properly attached.

8 Cleaning

Any other servicing should be performed by an authorized service representative.

- Unplug, discard remaining hot water and wait until the unit cools down before cleaning can be started.
- Only use clean soft materials such as cloth, sponge or paper towel.

Parts	Cleaning
<p>Inner container</p>	<p>1 Simply rinse thoroughly with water and wipe the inside liner with a clean sponge or paper towel.</p> <p>Caution</p> <ul style="list-style-type: none"> To prevent damage to the water heater do not use alkaline cleaning agents when cleaning, use a soft cloth and a mild detergent. Do not use any material such as a cleanser or scrubber for tough stains or mineral deposit; this is to avoid damage to the non-stick (fluoropolymer) coating surface. All water that contains minerals will leave mineral residue on the inside liner when boiled. If not cleaned for a prolonged period, mineral build up or stains may become tough or louder noises can be heard while boiling water. Frequent cleaning is recommended. Mineral deposit will eventually block the pipes and/or the steam vent if not removed. This blockage will cause the motor unit to burn when the "Dispense" key is pressed persistently. Do not scrub and/or do not use a knife to remove the mineral deposit. Discoloration caused by boil-dry is not removable.
<p>Exterior of the unit</p>	<p>2 For mineral build up, use citric acid cleaner every 2-3 months (refer to p.15)</p> <p>Uneven colors or discoloration of the inner container and floating white material in the water</p> <p>Red spots such as rust, milky white discoloration, black spots, iridescence that appear in the inner container, and floating white material are caused by a reaction of the minerals (calcium, magnesium, iron, etc.) contained in the water. This is not discoloration, rust, or peeling of the fluoropolymer-coated surface of the inner container itself. Although there are no sanitary / health concerns, frequent cleaning is recommended when the heater starts to show stains.</p>
<p>Power cord</p>	<p>Wipe off stains with a damp cloth or paper towel.</p> <p>Wipe off with dry cloth.</p>
<p>Mesh filter</p>	<p>Remove the mesh filter from inner container. Wash with soft brush e.g.: tooth brush.</p> <p>Caution</p> <ul style="list-style-type: none"> Frequent washing is recommended, this is to avoid clogging that may cause improper dispensing of hot water. After washing, be sure to attach the filter firmly to the inner container.

- Caution**
- Do not soak the unit in water and do not pour water on the unit, this is to avoid shorting or electric shock.
 - Never wash the entire unit, this is to avoid water getting inside the unit to cause malfunction.
 - Do not use harmful materials such as detergent, thinner, cleanser, bleach, metal scrubber, nylon scrubber, and chemically-treated wiping cloths.
 - Do not put in the dishwasher or dish dryer, this is to avoid deformation.

How to remove mineral deposit with citric acid.

Caution When washing the inner container with citric acid, be sure to follow the directions below, this is to avoid hot water spills or scalds.

- Do not fill with hot water. Be sure to wash with cold water.
- Do not fill with water above the full water level.
- Do not open the lid during cleaning cycle.
- Be aware of hot steam during cleaning cycle.

* Other functions are not available during cleaning cycle.

Citric acid can be purchased by contacting the Tiger product retailer where the heater was purchased, specifying product number PKS-0120 "citric acid (approx. 1.06oz / 30g x 4 packs) for cleaning the inner container of the electric heater".

* Citric Acid is used as natural food preservative. It is not harmful to your health.

Washing the inside container with citric acid (The guideline is once every 2-3 months)

- 1 Be sure that the mesh filter is set in the inner container.
- 2 Put approx. 30g (2-3 tablespoons) of citric acid into the inner container.
- 3 Pour water up to the full water level to mix, close the lid. (Refer to p.8)
- 4 Plug-in and keep pressing the **Temp. Set** key and the **Re-Boil/Timer** key at the same time for about 3 seconds.

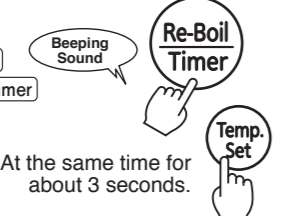

Washing will start. While the unit is being washed, the boiling lamp and the warmer lamp will alternately flash, notifying that washing is underway with the display panel changing as shown below. It will then switch to display the remaining washing time.

(Cleaning Time: 1 hour and 30 min)
* cleaning hour may vary depending in the water temperature.

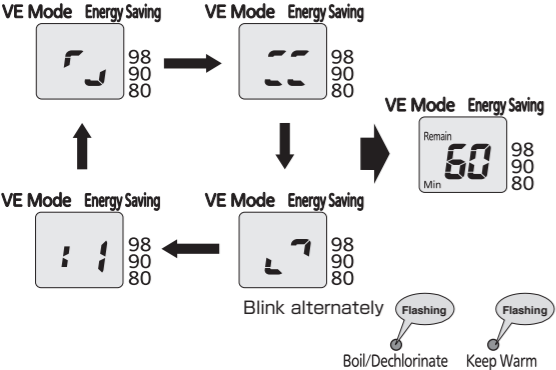

- 5 When washing is finished, the boiling lamp and the warmer lamp will illuminate. The display panel will indicate as follows:
 - Light illuminates (Boil/Dechlorinate)
 - Light illuminates (Keep Warm)
 - Recurring beeping sound (repeats 10 times)
- 6 Unplug and discard the hot water. If stains remain, scrub with a sponge and rinse well with water. *If mineral deposit is still attached on the wall of inner container, repeat the cleaning process.
- 7 To rinse remaining citric acid, refill with clean water and bring up to boil. Then discard half of water using **Dispense** key, open the lid discard rest of water.

Caution If you like to stop cleaning cycle, unplug the power cord. Be sure to discard citric acid water before use it again.

Washing the inside pump with citric acid (The guideline is once every 6 months)

Minerals may clog the inside pump, and hot water may not dispense. If this happens, wash the inside pump with citric acid according to the following procedure:

- 1 Remove the mesh filter from the inner container.
- 2 Dissolve approx. 30 g of citric acid (2-3 tablespoons) in approx. 1 cup of hot water (approx. 200 ml), and pour into the hole at the bottom of the inner container. Close the lid and let stand for about 2 hours.
- 3 Fill 1/3 of the inner container with water, close the lid, and plug-in to bring to a boil. (select the warmer temperature of 90)
- 4 Leave the unit at the warmer temperature of 90 for 2-3 hours.
- 5 Press the **Dispense** key and have the entire hot water (liquid of citric acid) discarded completely from the spout.
- 6 Unplug and wash the inner container with a sponge after the container has cooled down.
- 7 To rinse remaining citric acid, refill with clean water and bring up to boil. Then discard half of water using **Dispense** key, open the lid discard rest of water.
- 8 Attach the mesh filter once the unit has cooled down.

If not using for a prolonged period

- 1 Clean each part in accordance with the directions on p.14, and wipe with a dry cloth.
- 2 Dry each part. (The inside container must particularly be thoroughly dried.)
- 3 Place in a plastic bag, etc., and store sealed.

Caution If storing, be sure to tightly seal in a plastic bag, etc., so that no bugs or dust can get in.

Check the following before asking for a repair.

Symptom	Check	Action	Reference page
Water does not boil. (All the lamps are off and blank on display panel.)	Is the plug connected?	Connect the plug.	8
Does not start to boil after refilling the water. (Boil light does not lit)	Has the container been filled with hot water hotter than approx. 50°C?	Refill with either cooled water or cold water.	8
	Do you select VE Mode cycle?	Bring the water to a boil by pressing the Re-Boil/Timer key.	10
Hot water comes out on its own.	Is the water level above the "Full water level?"	Keep water below the "Full water level."	8
	Do you select Energy Saving Mode cycle? Selecting other cycle during Energy Saving Mode cycle, re-boil start automatically. You may hear boiling sound.	Bring the water to a boil by pressing the Re-Boil/Timer key.	9-10
There is a rasping sound when water is being boiled.	Is it the sound of bubbles bursting which are generated by the water being boiled, and it does not indicate a problem.		7
The sound of boiling seems louder than usual.	Do you select Energy Saving Mode cycle? Boiling will stop when temperature reach approx.98°C to reduce the boiling steam.		12
	Do you select Re-boil cycle? Re-boil cycle programmed to stop boiling below the boiling point.	Wash the inner container with citric acid.	15
Does not boil. (No steam)	Do you select Energy Saving Mode cycle? Boiling will stop when temperature reach approx.98°C to reduce the steam.	Select boiling cycle with dechlorinate.	8-10
	Do you select Re-boil cycle? Re-boil cycle programmed to stop boiling below the boiling point.		—
The hot water smells.	Depending on the amount of disinfectant chlorine in the tap water, the chlorine smell may remain.	Select boiling cycle with dechlorinate.	8-10
	Do you select Energy Saving Mode cycle? Boiling will stop when temperature reach approx.98°C to reduce the steam.		
The exterior of the unit is hot.	Although resin and other materials may smell for the first several times, they become less noticeable with use.		—
	Do you place the unit on resin tray or vinyl sheet? Water may absorb the resin smell.		
The inner container is dirty. White material is floating in the hot water.	If the unit is kept warm in a room with a high temperature, the exterior of the unit may become hot. This is not unusual.		15
	This is caused by a reaction of the minerals contained in the water, and it is not discoloration, rust, or the peeling of the fluoropolymer surface on the inner container itself.	Clean the unit with Citric Acid.	
The water is not hot enough.	Do you select Energy Saving Mode cycle?	Press Temp. Set or Unlock key. Bring up to setting temperature in a minute.	12
	Do you use VE Mode? Water temperature will decrease according with the elapsed time.	Select other keep warm setting or re-boil the water.	9-10
Water does not dispense using electric dispense key.	Low level of water may not retain temperature.		9
	The first cup of hot water may not be very hot, because the water stored in the water pipe of the water volume indicator comes out first.		—
Water does not dispense using electric dispense key.	Was hot water dispensed while the unit was tilted?	Place the unit completely upright.	—
	Is the plug connected?	Connect the plug.	8
	Is it set to lock automatically?	Press the Unlock key once to dispense hot water.	10
	Is it immediately after the water has boiled?	Open the lid once while watching out for steam.	

9 Troubleshooting

Symptom	Check	Action	Reference page
Water does not dispense using electric dispense key.	Are the mesh filter or the inside pump dirty?	Clean the unit with Citric Acid.	15
Water does not dispense when it use air pump dispenser.	Was hot water dispensed while the unit was tilted?	Place the unit completely upright.	—
	Be sure the gasket is set in proper position	Set the gasket in proper position.	18
	Be sure the gasket is not deteriorated or damaged.	Replace the gasket with new one. (Sold separately)	18
When water temperature decrease or water level is low, Air Pump Dispenser does not produce a smooth water flow.			11
	When water temperature decrease or water level is low, Air Pump Dispenser does not produce a smooth water flow.		11
Sound recognition (Beep 5 times) did not go off after boiling cycle is done.	Hot water may splash or does not dispense immediately after boiling cycle is done. Sound recognition go off 3 minutes after boiling cycle.		—
Display panels are fogged up.	Was the unit placed in an area prone to become wet or an area where the bottom can get wet?	Discard water, unplug, and leave until the panels are clear. If you still have cloud in the water scale, please contact customer service.	—
	Has the unit been placed upside down?		
	When refilling with water, was water splashed onto the operation panel?		

Display Messages

Symptom	Check	Action	Reference page
The unit is equipped with Boil-Dry Protection. Boil lamp and Keep Warm lamp flash alternately and signs (as shown) appear on the display.	Is there no water or very little water in the container?	Unplug, and refill to above the refill level of the water volume indicator. Leave as is for a while, then plug in.	8
	Has the unit been left for a prolonged period after all of the hot water was dispensed, or has lid been left open while refilling with water?		
The unit will notify you by beeping. Boiling Lamp and Keep Warm Lamp flash alternately (C1, C5, C6, C7, C8) will appear on the display as shown on left.	When refilling, is water being poured with excessive force?	Unplug, leave for a while, then plug in.	—
	When refilling or cleaning the heater, water may get inside the unit and cause problems. Request repair work from the Tiger product retailer where the appliance was purchased.		

Specifications

Capacity	2.91 L	
Power source	220V~230V	
Power consumption	Electric power for boiling water	624W~682W
	Electric power for the warmer	65W
Exterior size (approximate) (with the handle pushed down) (cm)	Width	21.5
	Depth	28.2
	Height	32.3
Weight (approximate) (including power cord) (kg)	3.1	

* Specified functions cannot be guaranteed in some areas (high altitude, extremely cold regions, etc.) Avoid using the unit in such locations.

Where to buy replacement parts and accessories.

Contact customer service

Gaskets (Consumer replaceable parts)

We recommend replacing the gasket annually or following these cases:

- Color changed to white.
- Any deterioration, spots become bigger.
- Steam coming out from gaps on the side.

Parts code	PDA1090
------------	---------

Resin parts

Resin parts may deteriorate over time due to contacting heat and steam. Replacement lid is purchase separately.

Mesh filter (consumer replaceable parts)

Attach mesh filter when cleaning the unit with citric acid. If mineral deposit is not removed, please purchase new one.

Parts code	PVH1045
------------	---------

How to replace lid gasket

How to remove

- 1 Unfasten the screws

- 2 Remove lid gasket

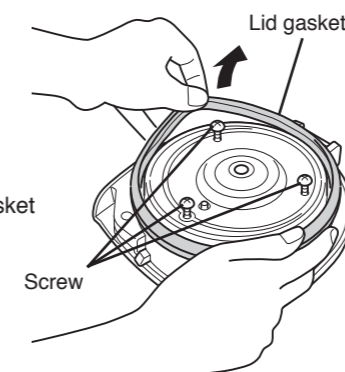

How to attach

- 1 Insert the lid gasket on to inner cover in proper position.

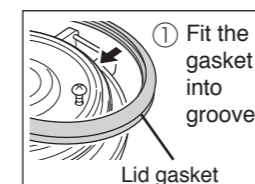

- 2 Run fingers around inner cover to press in to groove

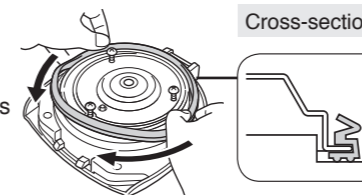

Be sure the gasket is attached properly.



- 2 Attach 3 screws securely.

Caution

- ◆ Do not remove inner cover from lid. Improper setting cause steam leakage and hot water does not dispense. If inner cover comes off, reattach the parts as shown below.

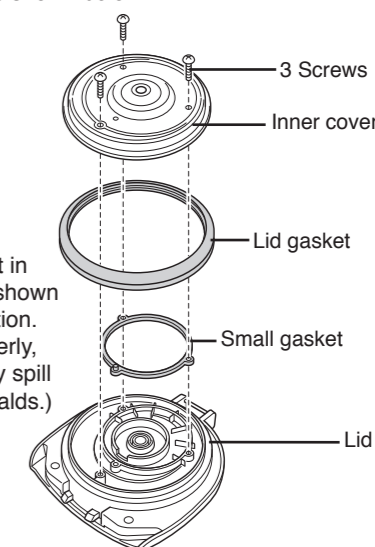

Be sure to set in the direction shown in this illustration. (If set improperly, hot water may spill and cause scalds.)

- ◆ After replace lid gasket still water does not dispense, other parts must be deteriorated as well. When figure (A) starts deteriorate, it is time to replace the other gaskets and plastic parts. Contact customer service.

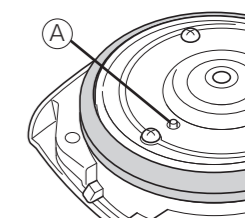

1 安全注意事項

使用前務必先詳讀並遵守安全注意事項

※此注意項目為事前防止對使用人及他人造成危險或財產損害所標示，內容攸關於安全性的問題，請務必遵守。

※貼在本體上的注意貼紙請勿撕下。

以下標示是防止疏忽注意事項並將其誤用時所產生的危險與損害的程度區分。

警告 表示「誤用時可能導致使用人死亡或受傷」的內容

注意 表示「誤用時可能導致使用人受傷害或物體損害」的內容

*1 重傷是指失明、負傷、灼傷(高溫、低溫)、觸電、骨折、中毒等所遺留後遺症狀，以及須住院治療或須長期至醫院檢查的情況。

*2 傷害是指必須住院治療或須長期至醫院檢查的負傷及灼傷、觸電等情況。

*3 物體損害是指房屋、家產及家畜、寵物等擴大損害的情況。

記號說明

 △記號代表警告、注意。具體的注意事項會標示在記號中或在附近以圖文標註。

 ⊘記號代表此行為是禁止的。具體的禁止事項會標示在記號中或在附近以圖文標註。

 ●記號代表此行為請務必實行。具體的指示事項會標示在記號中或在附近以圖文標註。

有嬰幼兒的家庭在使用時請特別注意

警告

 不要讓小孩獨自使用或讓幼兒碰觸。
恐造成燙傷、觸電、受傷。

 不要讓幼兒舔器具用插頭。
要小心勿使嬰幼兒誤舔插頭。
恐造成觸電及受傷。



 身體障礙者或未充分理解製品使用方法者，請勿單獨使用本製品。使用時，務必需要充分理解製品使用方法者在場確認。
否則，可能造成燙傷、觸電及受傷的事故。

 上蓋左右發出「喀噠」聲才表示已確實蓋緊。
以免萬一傾倒熱水流出被燙傷。

 臉和手不要靠近蒸氣孔。
恐造成燙傷。
特別要注意不要讓嬰幼兒觸摸。

注意

 不要在不穩定的場所或不耐熱的墊子上使用。
傾倒時熱水會流出，恐造成燙傷。
另外也可能導致火災發生或是桌面、桌巾等的變色及變型

警告

 請勿改造。
非技術人員請勿進行拆解、修理。
可能導致火災、觸電、受傷。

 濕手不要拔出/插入插頭。
恐會觸電及受傷。
請勿用濕手觸碰

 不要使用額定電壓以外的電流。
恐會引起火災、觸電。

 不要加水超過滿水位。
恐熱水噴出，造成燙傷。
另外，水量若少於給水記號時，容易導致容器內部變色及故障。

 單獨使用規格7A以上的電源插座。
與其他電器共用時，分路插座處會因過熱而起火。

 不要用力蓋上蓋子。
恐熱水噴出，造成燙傷。

 不要使用已受損的電源線，並且不要讓電源線破損。
(加工、勉強扭曲、靠近高溫部位、硬扯、扭轉、束起、承載重物、夾住等)
恐引起火災、觸電。

 不要用抹布蓋住蒸氣孔。
恐熱水噴出，造成燙傷並會造成上蓋變形。

 插頭上如有灰塵附著，要仔細清除。
以免引起火災。

 不要煮沸水以外的物品。
如果放入茶葉、牛乳、酒、茶包或沖泡食品時，恐會產生泡泡噴出，造成燙傷。且會造成內容器燒焦、腐蝕、故障、氟素加工的剝落。

 插頭要緊緊插進插入口最裡面。
恐會引起觸電、短路、冒煙、起火。

 電源線及插頭如有損傷或插口插入鬆脫時不要使用。
恐造成觸電、短路、起火。

 不要放入冰塊當作保冷使用。
如果放入冰水或冰塊會結露，恐造成觸電、故障。

1 安全注意事項

警告



不要雙手環抱、傾斜、搖晃、上下用力搖動、碰撞。不要只拿蓋子搬動。

即使「上鎖」也請勿傾倒。會造成熱水流出或有燙傷的危險。



不要翻倒瓶體。

即使「上鎖」也請勿傾倒。會造成熱水流出或有燙傷的危險。



請勿沾濕

本體請勿沾濕，也請勿潑水。

恐造成短路、觸電、起火。



上蓋未取下，不要倒掉剩下的熱水。

當上蓋脫落時，熱水濺出恐造成燙傷。
(剩餘熱水的丟棄方法請參照P.22、29)



若上蓋墊圈已變白色請盡快更換。

為了避免翻倒時熱水漏出造成燙傷



發生異常或故障時，請立即停止使用。

若繼續使用，可能會造成火災、觸電或受傷。

(異常、故障範例)

- 使用中電源線是否會異常發熱。
- 插上電源的電線是否扭曲。
- 溫度是否異常過高是否有燒焦味。
- 本體是否會漏水。
- 出現其他異常或故障。

請立刻拔下電源插頭，聯絡原購買店家進行檢查與維修。

注意



拔取插頭

不使用時將插頭從插入口拔下。

恐造成受傷、燙傷、因絕緣劣化而引起的觸電、漏電火災。



拔下插頭時，一定要握住插頭處拔出。

以免觸電或因短路起火。



不要使用非本產品專用的電源線。不要將電源線轉到其他電器用品上使用。

恐造成故障、起火。



不可使用延長線。可能造成火災。



不要放容易被水噴到的場所、或是底部容易沾濕的地方使用。

會造成短路、觸電、故障。



不要直接從水龍頭接水。

本體內部一旦進水會造成短路、觸電、故障。



不要在牆壁或是傢俱附近使用。

可能因為蒸氣或是熱氣對牆壁或傢俱造成傷害，導致變色、變型。若放置廚房的收納架上使用時，請注意不要讓蒸氣滯留。

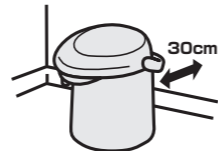

打開上蓋時不要碰觸冒出的蒸氣。

以免燙傷。

禁止觸碰

注意



燒水中不要加水使用。

熱水會飛濺，造成燙傷。



使用中不要轉動本體。

熱水會飛濺，造成燙傷。



禁止觸碰

使用中及使用後暫時不要觸碰高溫部份。

以免燙傷。



搬運本體時，不要觸摸上蓋的開閉桿。

上蓋會打開造成燙傷或受傷。



保養時要冷卻後再進行。

觸摸高溫處恐遭燙傷。



清洗之前，請務必從插座上拔下插頭，並將器具插頭從本體的插頭口拔下。清洗後重新使用本製品時，需確認電源線的插頭、器具插頭及本體插頭口已充分乾燥後，再插上各自的插頭。

否則，可能造成短路、觸電及起火的故事。



剩餘熱水要倒掉時一定要從下圖方向倒出。

如果從其他位置傾倒，熱水會進入本體內部而造成故障，也可能被燙傷。

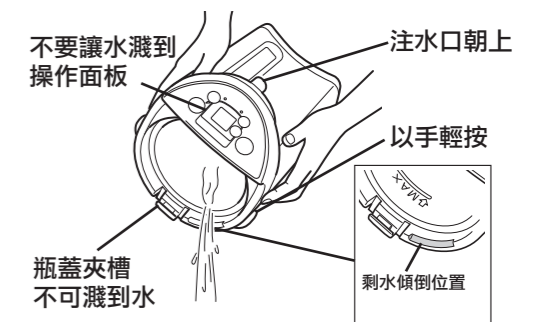

不要整個拿去清洗。本體內部或是底部不要進水或弄濕。

會造成短路、觸電、故障。



不要將本體倒放。

若底部有水，有可能會滲入本體造成故障的原因。



本產品是一般家電，亦可於下列場所使用。

- 商店或辦公室等的專用廚房。
- 農家。
- 飯店、汽車旅館或其他住宿設施。

為能永續使用，請務必遵守

- 不要在火源附近使用。恐造成變形、故障。
- 不要在日光直射較長的場所使用。本體變熱時恐引起故障。
- 不要空燒。瓶內沒水而通電時，會造成內容器熱變色、故障。
- 不要放入備長炭之類的炭。恐造成故障、氟素加工剝落。

2 各部的名稱與功能

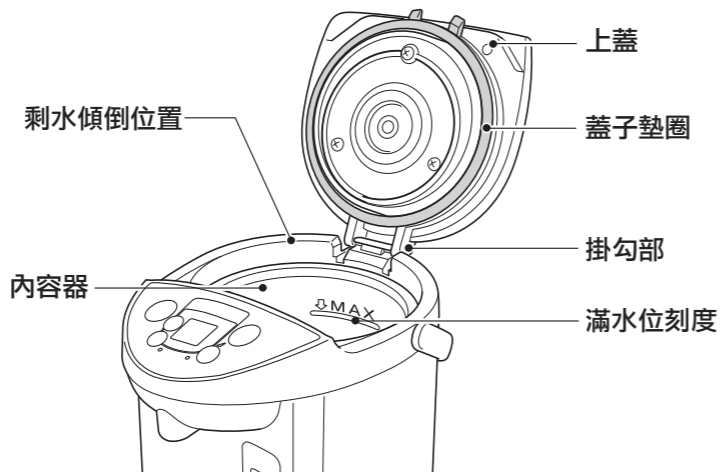
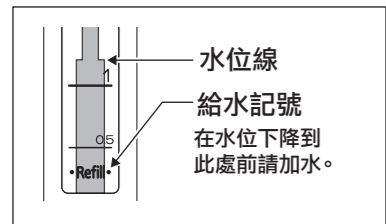
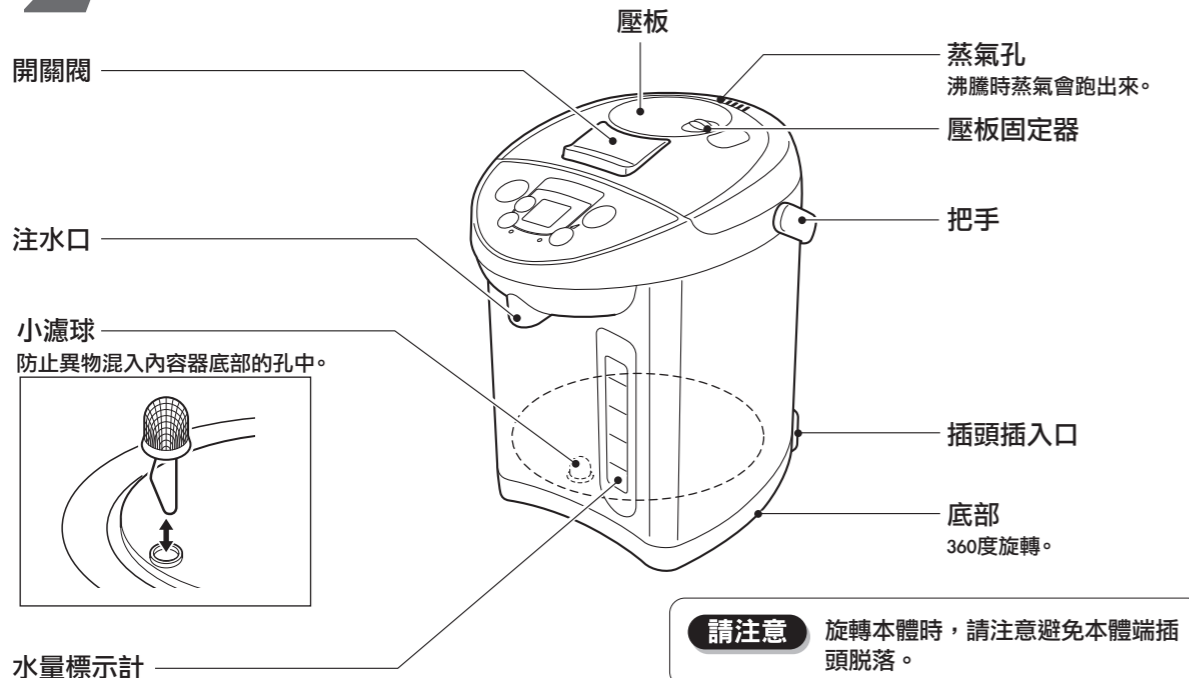

本使用說明書所記載的數值98、90、80為保溫溫度的參考數值。

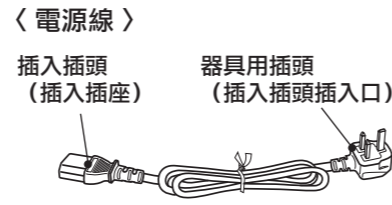
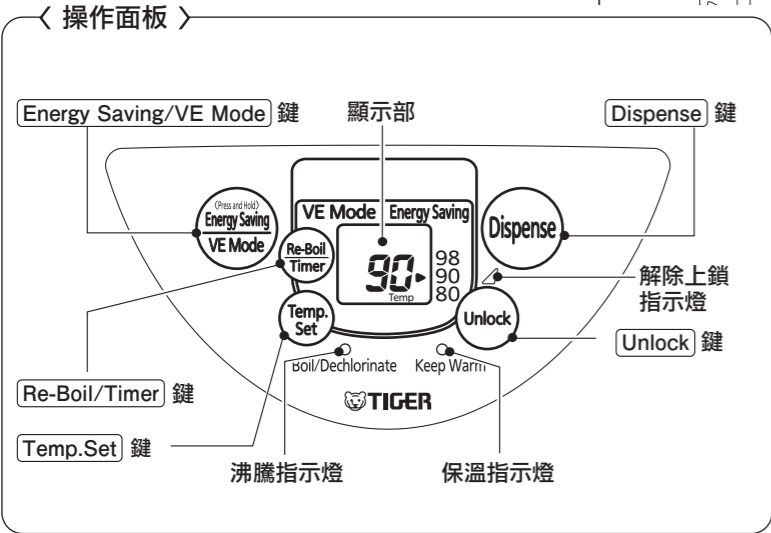

聲音提示

在煮水時會發出「咕嘟」的聲音，那是在內容器產生的水泡裂開之聲響，並非故障。

3 煮水的方法

第一次使用本產品或暫時沒有使用時

清洗本體，請依照以下步驟將沸騰的熱開水倒掉。第一次使用時，會有樹脂等氣味的可能，將隨著使用後減少。

- 1.請加水至滿水位，開始煮水。→請參照以下
- 2.水煮開後，用電動出水的方式壓出約半桶的水倒掉。→請參照P.26
- 3.拔除插頭·上蓋後將剩下的水倒掉。→請參照P.29

1 打開上蓋。

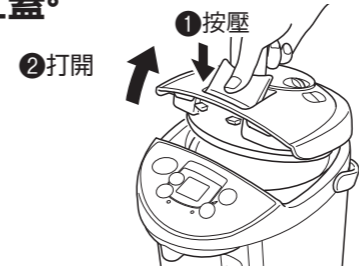

((聲音)) 在開閉上蓋時，會發出「喀啦喀啦」聲，那是為了萬一翻倒防止熱水流出的氣閥音並非異常。

2 用燒水壺注入生水。

生水請注入到「給水記號」以上至「滿水位刻度」之間。

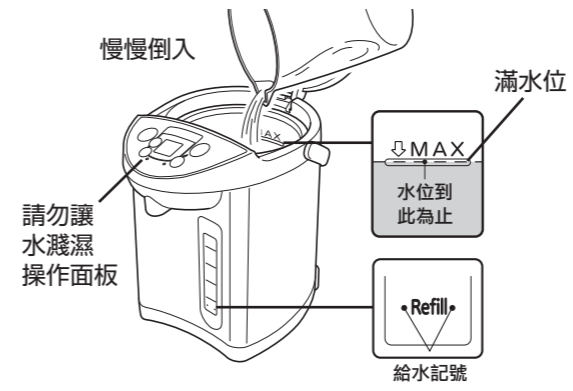

- 請勿從水龍頭直接加水，或將本體置放在潮濕的地方。底部請勿沾濕。
- 若加入約50°C以上的水，會造成無法自動煮水的情形，請加入冷水或讓水再次沸騰。(請參照P.26)
- 請勿將水加超過「滿水位」，或低於「給水記號」的水量煮水。

3 蓋上蓋子。



請注意 上蓋若沒有確實蓋上，翻倒時熱水會大量湧出，造成燒燙傷。

4 連接電源線。

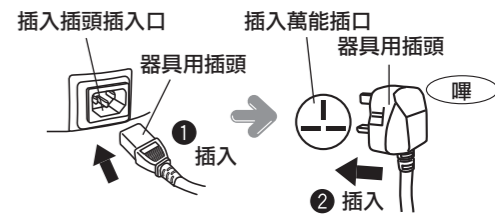

5 開始煮水。

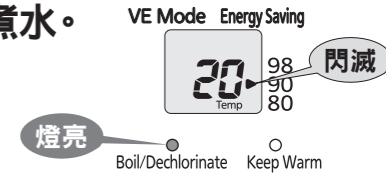

※要選擇保溫溫度時參照P.25 6。(不選擇時會自動變成90°C保溫)

※設定節電定時器時參照P.29。

欲減少水中的氯氣味時

按一次 [Re-Boil/Timer] 鍵。

※會比正常煮水的時間長。

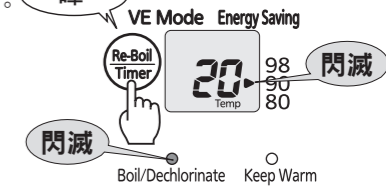

3 煮水的方法

6 選擇保溫

用 [Temp.Set] 鍵或 [Energy Saving/VE Mode] 鍵選擇。

■ 98(約98°C) • 90(約90°C) • 80(約80°C)
溫度保溫時

每按一次 [Temp.Set] 鍵將跳至下一個溫度。

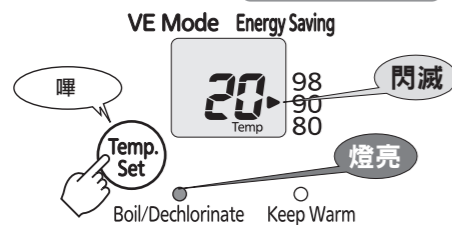

■ 真空保溫時

按下 [Energy Saving/VE Mode] 鍵。
再次按壓時會切換保溫溫度的選擇。

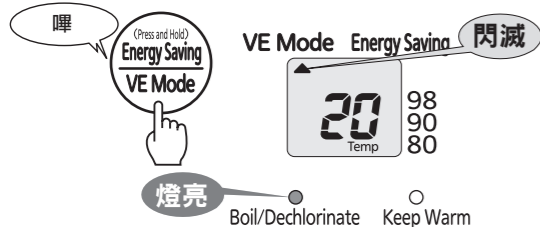

- 共有4種保溫設定供選擇。
(80·90·98溫度保溫3種溫度及真空保溫)
- 真空保溫沸騰後，電熱器將自動關閉。
- 煮水中或保溫中皆可變更保溫的溫度設定。

請注意

- 在設定中，如果插頭脫落，再度插上插頭時，會變成90保溫。
- 欲設定真空保溫時，請勿長壓按鍵，以免設定成節能功能模式。(請參照P.28)

■ 煮水中...

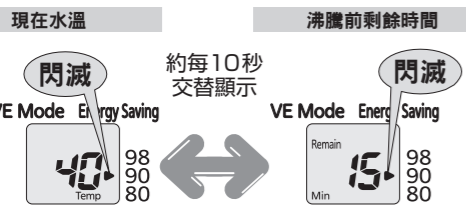

※沸騰前剩餘時間開始顯示的時機，因水量、水溫而不同。

※熱水溫度以每5°C顯示。
(大約98°C時會顯示「98」)

7 自動保溫。

■ 煮沸時

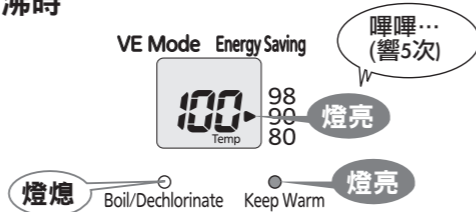

■ 變成設定的保溫溫度時

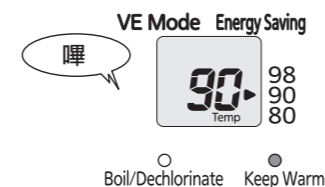

請注意

- 請勿觸碰蒸氣孔噴出的蒸氣，恐造成燙傷。
- 在煮水中或煮水後，請勿用力開閉上蓋或取用熱水，恐熱水飛濺或蒸氣孔噴出蒸氣，造成燙傷。

到達沸騰時間與自選保溫溫度所需時間標準

生水到煮沸	約31分
煮沸到90保溫	約3小時45分
煮沸到80保溫	約6小時50分

※水量：滿水位、水溫：室溫：23°C、電壓：額定電壓時。
※生水煮沸到98保溫的時間，大約和生水到煮沸的所需時間相同。

沸騰後的水溫基準 (真空保溫時)

隨著時間水溫也會慢慢降溫。水量少時容易冷卻。

2小時後	約91°C以上
------	---------

※水量：滿水、室溫：23°C時的參考值。
※溫度是以每5°C為一個單位顯示，
與熱水瓶內的水溫會有些許差異。

4 取用熱水的方法

以電動式出水的方法

1 按1次 [Unlock] 鍵。

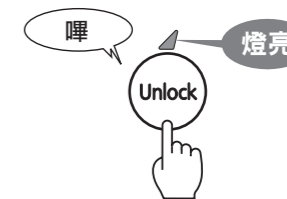

2 按壓 [Dispense] 鍵。

將盛水容器放置出水口後按 [Dispense] 鍵。
按住時，從出水口會流出熱水。

- ※ 確定熱水出完後，將容器從出水口拿開。
- ※ 取下插頭後即無法給水。
- ※ 沸騰後所產生的氣泡會造成熱水不易出水。請小心蒸氣並打開上蓋後再蓋上上蓋取水。
- ※ 內容器或小濾網、本體內部的出水管若有污垢，會造成不易出水的情形。
(請用檸檬酸洗淨清潔。→請參照P.31)
- ※ 取用熱水後，約10秒未按 [Dispense] 鍵，解除上鎖燈會熄滅，給水會被自動鎖住。

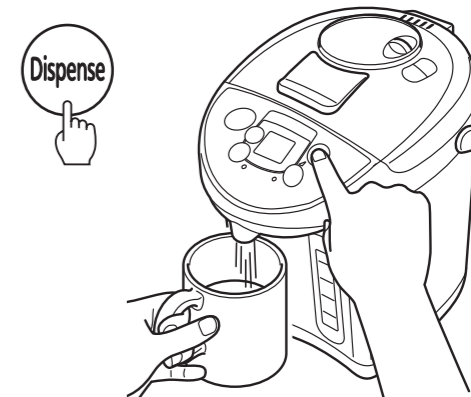

請注意

- 熱水量少時，請勿取水。以免熱水飛濺噴出。
- 取用熱水時，請注意勿使本體轉動，恐熱水溢出造成燙傷。

若在保溫中要再次煮沸時，
請按一次 [Re-Boil/Timer] 鍵。

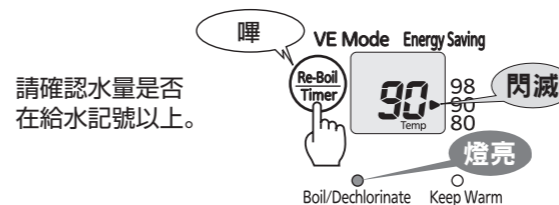

請確認水量是否在給水記號以上。

滿水位時再沸騰所需時間的基準

98·90保溫	約4~9分
80保溫	約9~11分

※中途加水或重新插上電源插頭時煮水時間會變長。
※真空保溫時，直到沸騰的時間會不同。

■ 保溫中想減少熱水中的氯味時

按2次 [Re-Boil/Timer] 鍵，
即開始再煮沸。

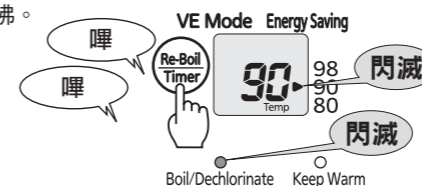

每按一次 [Re-Boil/Timer] 鍵將切換各設定。

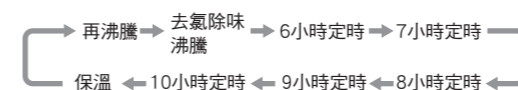

※ [Re-Boil/Timer] 鍵與節電定時鍵兼用，請對照液晶顯示部設定。

4 取用熱水的方法

3 按1次 Unlock 鍵。

Dispense 鍵上鎖，即使按壓，也無法給水。

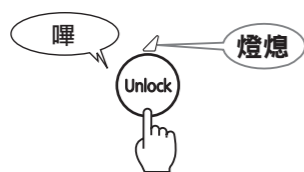

■若沒有水時，請務必加水。

水量接近「給水記號」時，請務必加水並蓋上上蓋。(加水時請注意蒸氣。請參照P.24)

- 請注意**
- 不要在空瓶狀態下放置，以免因空燒而造成故障。
 - 設定(真空保溫)時(插上電源插頭的狀態之下)，即使加水也不會自動煮水。

以氣壓式出水的方法

即使拔除電源線仍然可以出水。

1 將壓板固定器調在「Unlock」位置。

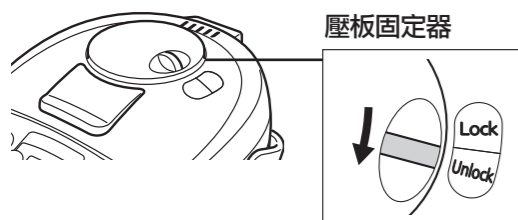

2 慢慢按下壓板。

將要裝熱水的容器靠近出水口，慢慢按下壓板。



※放開壓板，確認出水口已經沒有熱水出來後再將容器移開。

※出水量會稍微比電動出水的量少。

※熱水冷卻或水量減少時，氣壓出水的熱水量也會逐漸減少。

- 請注意**
- 請慢慢按下壓板。過力按壓會造成熱水飛濺噴出或水出不來等情形。
 - 熱水量少時，請勿取水。以免熱水飛濺噴出。
 - 取用熱水時，請注意勿使本體轉動，恐熱水溢出造成燙傷。
 - 避免燒燙傷或故障，請勿同時使用電動出水及氣壓出水。

3 將壓板固定器調在「Lock」位置。

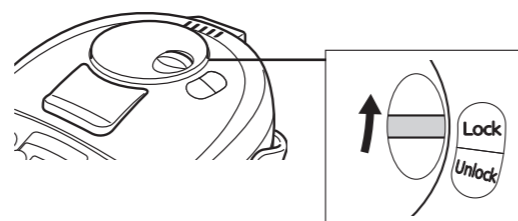

壓板上鎖後，即使壓下也不會出水。

■水量變少時請務必加水。

水量接近「給水記號」時，請務必加水並蓋上上蓋。(加水時請注意蒸氣。請參照P.24)

- 請注意**
- 不要在空瓶狀態下放置，以免因空燒而造成故障。
 - 設定真空保溫時(插上電源插頭的狀態之下)，即使加水也不會自動煮水。

5 節能功能模式的使用方法

選擇節能功能模式時，可進行節能煮水及節能保溫功能。

- 節能煮水時，會在煮沸前關閉電熱器並進入減少蒸氣量的調整。煮水完成的溫度會控制在約98°C。(會依據室溫·水量·氣壓等條件不同，蒸氣量會有不同情形。)
- 使用節能保溫若2小時以上沒有使用時，設定溫度會降約5°C後持續保溫。(例如設定98保溫時，節能保溫會變成95持續保溫。)

1 選擇節能功能模式。

長壓(約1秒) [Energy Saving/VE Mode] 鍵，選擇節能功能模式。

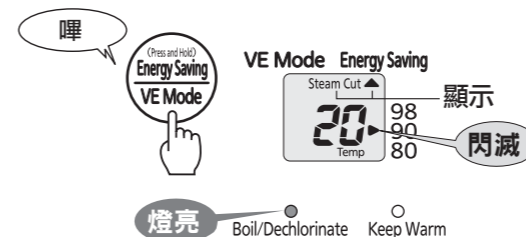

■不讓節能功能模式消除蒸氣時(讓水沸騰)

使用「去氯除味」模式煮水。(請參照P.24)

2 選擇保溫 (P.25 參照)

3 煮水完成後將自動跳到保溫

■煮水完成後...

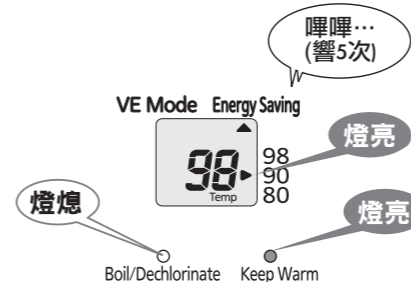

■降到設定的保溫溫度時...

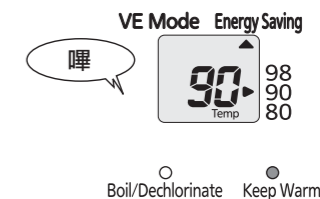

■2小時以上沒有使用時將自動切換到節能保溫模式 (設定溫度會降約5°C保溫)

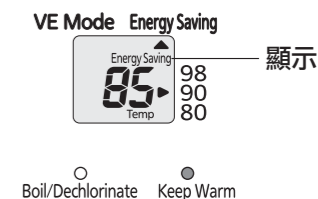

※真空保溫時，電熱器不會啟動，熱水會慢慢降溫。

欲將節能保溫的水溫調回原先設定的溫度時

按住 [Temp.Set] 鍵或 [Unlock] 鍵約1分鐘，即可恢復至預設溫度。

欲解除節能功能時

長壓(約1秒) [Energy Saving/VE Mode] 鍵。(水溫較低時，將自動煮水。)

聲音 在節能保溫中操作面板時，產生的「吼」聲是為了將水溫恢復到預設溫度所產生的自動煮水聲。(請參照 P.32)

請注意 節能煮水時，蒸氣孔仍為高溫。為避免燒燙傷，請勿觸摸或將臉靠近。

6 節電定時的用法

節電定時共有5個階段供選擇，可從約6小時後至約10小時後的每隔1小時時段做為設定。外出時或睡前設定節電定時，電熱器會自動關閉，進入真空保溫模式可節省電費。經過了設定的時間後將開始照常煮水。

請按下 Re-Boil/Timer 鍵，選擇節電的時間。

請看顯示部對照確認。

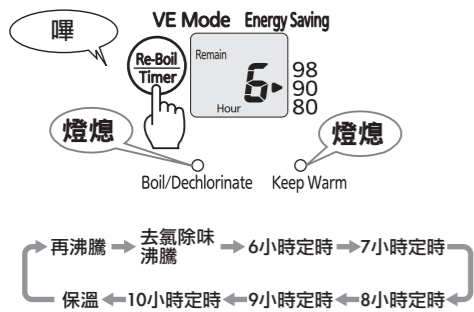

※節電定時結束前的剩餘時間以每1小時顯示。

■如果在設定時間前1小時...

會開始煮沸，以每59~1分顯示。

■煮沸結束時...

會以設定好的溫度保溫。

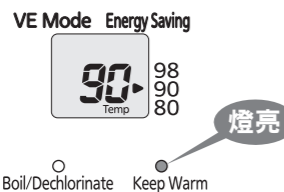

- 請注意**
- 設定節電定時會無法出水。
 - 請勿在真空保溫模式時設定。電熱器不會啟動，熱水會慢慢降溫。

解除節電定時進行煮沸時

按 [Re-Boil/Timer] 鍵讓沸騰指示燈亮起。即開始煮沸。

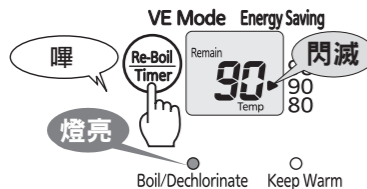

7 用完後

1 拔下插頭。

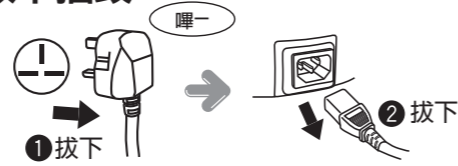

2 拆下上蓋。

一邊按住上蓋裝卸桿
一邊將蓋子朝注水口側拉即可打開拆下。

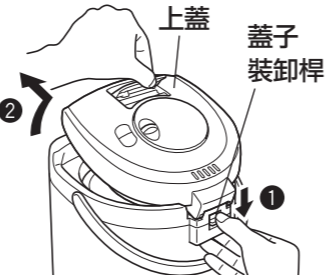

3 倒掉殘餘熱水。(參照P.22)

- 請注意**
- 為了避免熱水飛濺，倒掉熱水時請盡量靠近水槽慢慢倒掉。
 - 倒掉熱水後，有可能會從出水口滴出殘水，請小心。
 - 使用後請經常清洗內容器及小濾網。(請參照P.30)

4 安裝上蓋。

一邊按住上蓋裝卸桿
一邊將蓋子掛勾處插入。

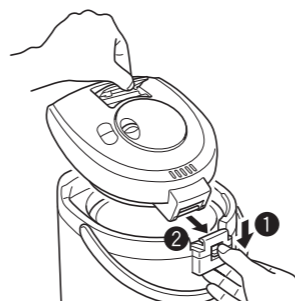

- 請注意**
- 殘餘開水不要保留，否則會造成內容器變色或產生味道。
 - 不要在未打開上蓋或注水口向下由鉸鍊處倒水，以免熱水濺到手上而燙傷或造成故障。
 - 小濾球的安裝如不確實，在倒掉殘餘熱水時有時會鬆脫掉落，要小心。

8 保養方法

有關其他維修、售後服務、請務必委託本公司指定的保修人員。

- ◆ 拔下插頭，倒掉殘留的熱水，讓本體冷卻後再進行。
- ◆ 使用較柔軟的海棉、布等。

各部位	保養方法
內容器	<p>1 拆下小濾球用海棉清洗。</p> <p>請注意</p> <ul style="list-style-type: none"> ●清潔保養時，請勿使用鹼性的清潔劑清洗。請使用柔軟的布及溫和的清潔劑清潔。 ●去污粉或刷子類請勿使用，否則氟素加工面會受損，使污垢不易去除。 ●即使經過氟素加工，如果長時間不做保養，污垢會黏住而不易清除，煮水時聲音也會變大，請仔細地保養。 ●因空燒而形成的變色無法去除。 ●煮沸礦泉水或鹼離子水時，內容器容易附著鈣成份，或附在上面的鈣成份剝落而堵住本體內的熱水及蒸氣之出口，造成故障，故請更加小心仔細清除。 ●請勿用力刷洗或用刀子去除附著在內容器的礦物成份。
上蓋	<p>2 海棉也無法清除的污垢，請用檸檬酸(另售)清洗(2~3個月1次)。(參照P.31、32)</p> <p>■有關內容器色斑、變色、水中有白色浮游物</p> <p>內容器產生的如生鏽的紅斑點、乳白色、黑色、彩虹般的變色、白色浮游物是因為水中所含的礦物成份(鈣、鎂、鐵等)作用下而生成的。並非內容器本身變色或腐蝕、氟素樹脂剝落。衛生上全無問題，如果太明顯，則請仔細清除。</p>
本體外側	<p>用充份擰乾的抹布擦去污垢。</p>
電源線	<p>用乾布擦拭。</p>
小濾球	<p>請從內容器取下用小刷子仔細清洗。</p> <p>請注意</p> <ul style="list-style-type: none"> ●仔細洗淨，一旦堵塞，熱水將不易流出。 ●清洗後一定要確實裝回內容器。

- 請注意**
- 本體請勿泡在水裡或沖水，恐造成短路、觸電。
 - 請絕對不要整個拿去清洗，如果本體內部進水會造成故障。
 - 請勿使用洗潔劑、稀釋劑、去污粉、漂白劑、金屬刷、尼龍刷、化學抹布等。
 - 請勿使用碗盤清洗機或烘乾機，以免造成變形。

8 保養方法

使用檸檬酸清洗的方法

- 請注意** 在進行內容器的檸檬酸清洗時一定要遵守以下內容，否則在起泡泡時，熱水飛濺恐遭燙傷。
- 勿加熱水，一定要以生水進行清洗。
 - 勿超過滿水位。
 - 清洗中請勿打開上蓋。
 - 清洗中會沸騰小心蒸氣。

※進行檸檬酸清洗時，無法使用其他操作及功能。

檸檬酸請向虎牌產品銷售店詢問

指定編號：PKS-0120「電熱水瓶內容器洗淨專用檸檬酸(約30g x 4包入)」，洽購。
※檸檬酸清潔劑為食品添加物，食品衛生上為無害。

內容器的檸檬酸清洗(約2~3個月做1次)

- 1 確認內容器裡的小濾球裝在上面。
- 2 檸檬酸1包(約30g)放入其他容器用溫水化開。
- 3 加入冷水再倒入化開後的檸檬酸液體到滿水位後蓋上上蓋。(參照P.24)
- 4 插上插頭，同時連續按 **Re-Boil/Timer** 鍵與 **Temp. Set** 鍵約3秒。

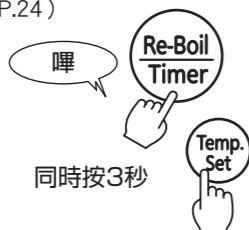

開始清洗。清洗中沸騰指示燈與保溫指示燈交替閃滅，液晶顯示會如下圖移動予以通知。然後切換到清洗剩餘時間的標示。

(洗淨時間約1小時30分*) *依水溫有所差異。

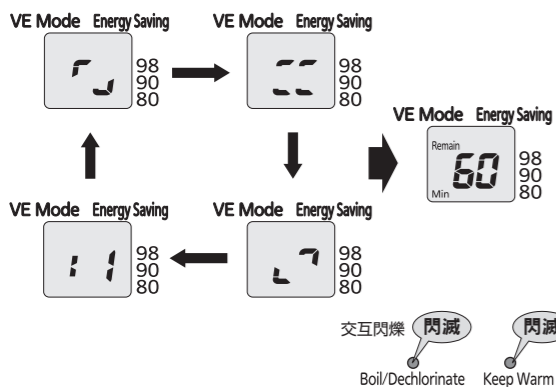

- 5 清洗完成時沸騰指示燈及保溫指示燈變成熄燈狀態，液晶顯示會變成如下圖：

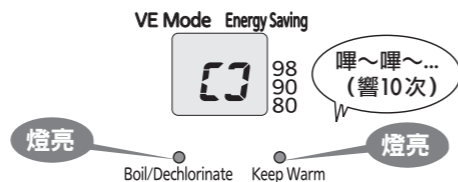

- 6 拔下插頭，倒掉熱水。如果還有污垢，則用海棉擦掉，再用水充份洗淨。
※污垢不易去除時，水沖洗後，請再放入檸檬酸與水進行同樣操作。
- 7 為除去檸檬酸的味道，可以只用水再一次煮沸後倒掉熱水。

請注意 使用檸檬酸清洗途中如欲解除，請拔掉插頭。要跟平時使用一樣煮沸的話，一定要把原來的液體(檸檬酸的液體)倒乾並沖洗乾淨之後才可使用。

內部幫浦的檸檬酸洗淨(每半年1次)

內部的幫浦一旦附著凝固的礦物質成份，熱水將不易流出。此時，請按照以下順序用檸檬酸清洗內部的幫浦。

- 1 將小濾球自內容器取拆下。
- 2 將大約30g(大匙2~3匙)檸檬酸溶解在1杯熱水(約200ml)中放入內容器底部小洞中。
- 3 加水達內容器的1/3處，蓋上蓋子，插上插頭讓它煮沸。(選擇90保溫)
- 4 在90保溫狀態下靜置2~3小時。
- 5 按 **Dispense** 鍵，將熱水(檸檬酸的水液)全部從注水口倒掉。
- 6 拔下插頭，冷卻後用海棉洗淨內容器。
- 7 要除去檸檬酸的味道可只用清水再度通電煮沸，把熱水倒掉，冷卻後裝回小濾球。
- 8 等冷卻之後再安裝小濾球。

長時間不用時

- 1 按P.30要領保養各部位再用乾布擦拭。
- 2 讓各部位自然風乾。(特別是內容器要充份乾燥)
- 3 用塑膠袋等密封保存。

請注意 保存時，請用塑膠袋等密封，避免螞蟻等爬入。

9 懷疑是故障時

在送修前請確認。

這樣的情形時	看這裡	請這樣處理	參照頁次
不能煮水(所有的燈及顯示部皆消失。)	插頭有無脫落。	請插上插頭。	24
加入水後，沒有開始煮水。(沒有切換到沸騰燈。)	是否放入約 50°C 以上的熱水。	請放入稍涼的熱水或生水。	24
	是否設定為真空保溫(通電狀態)。	請按 Re-Boil/Timer 鍵，使其沸騰。	26
熱水自然流出	是否水位超過「滿水位刻度」。	「請降到「滿水位刻度」以下。	24
	是否設定為真空保溫(通電狀態)。	請按 Re-Boil/Timer 鍵，使其沸騰。	25:26
煮水中出現「咕嘟」聲	煮水中所產生的水泡迸裂的聲音，不是故障。		23
	是否選擇節能功能。在節能保溫中若有操作面板，將自動恢復到原先所設定的預設溫度。聲音為此時所產生的氣泡聲。		28
煮水聲音比平時大	內容器是否髒了。	使用檸檬酸洗淨功能清洗內容器和本體內部的出水管。	29
不會沸騰。(沒有出現蒸氣)	是否選擇節能功能。為了減少蒸氣，利用節能煮水的情形之下，機器會在約 98°C 時結束煮水。	使用「去氯除味」功能煮水。	24:26
	是否按了再沸騰。再沸騰會將已經煮沸過一次的熱水再次煮沸，機器有設定減少蒸氣。		—
開水有味道	因自來水中所含消毒用的氯使用量不同而會殘留消毒水味。	使用「去氯除味」功能煮水。	24:26
	是否選擇節能功能。為了減少蒸氣，利用節能煮水的情形之下，機器會在約 98°C 時結束煮水。		
本體外側發熱	剛開始使用時，有時會有樹脂等味道，隨著使用時間久後會變少。	—	
	是否在塑膠片等墊子上使用。墊子的味道有時會傳到熱水裡去。		
內容器髒污	那是在水中所含礦物質成份作用下而產生的，並非內容器本身的變色或腐蝕、氟素樹脂剝落。	使用檸檬酸洗淨。	31
熱水是溫的	是否選擇節能功能。利用節能保溫時，預定溫度會降約5°C維持保溫。	按住 Temp. Set 鍵或 Unlock 鍵約1分鐘，即可恢復至預設溫度。	28
	是否設定為省電保溫模式。將隨時間經過，水溫會慢慢下降。	選擇其他保溫模式。或按 Re-Boil/Timer 鍵煮水。	25:26
電動出水，無法出水時。	若在水量少的狀態下使用「真空保溫」模式，熱水容易冷卻。	25	
	因第1杯熱水積存在水量顯示計的水量管中，熱水流出會是溫水。	—	
不能煮水(所有的燈及顯示部皆消失。)	是否本體在傾斜狀態下給水。	請將本體扶正。	—
	插頭有無脫落。	請插上插頭。	24
	是否在自動鎖住的狀態。	請按1次 Unlock 鍵後即可給水。	26
沸騰後是否立刻取水。	請小心蒸氣打開一下上蓋。	26	

9 懷疑是故障時

這樣的情形時	看這裡	請這樣處理	參照頁次
電動出水，無法出水時。	內容器小濾球或內部幫浦是否髒污。	使用檸檬酸清潔洗淨。	31
氣壓出水，無法出水時。	是否本體在傾斜狀態下給水。	請將本體扶正。	—
	上蓋墊圈是否脫落。	請重新將上蓋墊圈正確安裝。	34
	上蓋墊圈是否已受損。	更換新的上蓋墊圈(另洽購)。	34
	水若變冷或變少時，氣壓出水的出水量會變少。		27
蒸氣散出後，提示音(「嗶」5次聲響)仍然沒有響起。	若剛沸騰時立即出水，沸騰所產生的氣泡易堵住水管導致不易出水，或熱水飛賤。為避免這種情形，機器蒸氣散出後將有3分鐘不會響起。		—
顯示部份有霧氣。	是否置放在容易沾到水或是底部容易沾濕的地方。	請將水倒掉，並以沒有通電的狀態下讓霧氣散去。	—
	本體是否倒置。	霧氣無法消除時，請送至虎牌購買處維修。	
	給水時，操作面板是否沾到水。		

有下列情形時

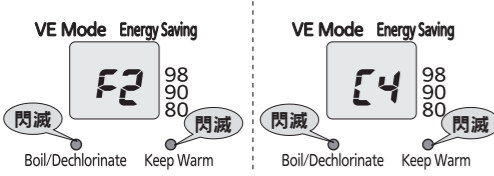
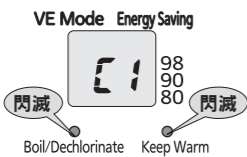
這樣的情形時	看這裡	請這樣處理	參照頁次
防止空燒功能運作時，沸騰指示燈和保溫指示燈會交互閃爍。如下圖表示。 	<p>是否在空燒或水量太少。</p> <p>是否熱水已用完，卻仍長時間任其靜置，或為了加水而任由上蓋開著。</p> <p>加水時是否加得太快。</p>	<p>拔下插頭，加水直到給水記號以上，過一會再插入插頭。</p> <p>拔下插頭，稍待一會再插回。</p>	24
發出「嗶嗶嗶...」聲，沸騰指示燈和保溫指示燈交互閃爍。如右圖(C1·C5·C6·C7·C8)。 	—	可能在給水或整理時本體內部因進水而產生故障。請洽經銷商進行修理。	—

規格

額定容量	2.91 L	
電源	220V~230V	
消耗電力	煮沸電力	624W~682W
	保溫電力	65 W
外形尺寸(約) (將把手傾倒的狀態)	寬	21.5 cm
	深	28.2 cm
	高	32.3 cm
重量(約)(含電源線)	3.1 kg	

※ 特定地區(高山、嚴寒地區等)有時會無法確保原有性能。

關於消耗品·耗材洽購

請至全省虎牌直營門市洽購

上蓋墊圈(消耗品)

請以1年為基準做確認，若出現以下情形請更換。
(翻倒時熱水漏出，有燙傷的危險)
·變白。(裂化前現象)
·污損明顯。
·從上蓋的縫隙中會散出蒸氣。

零件型號	PDA1090
------	---------

樹脂零件(受損時)

會接觸到熱及蒸氣的樹脂零件，會隨使用情況而受損，請更換零件。(另洽購)

小濾網(消耗零件)

即使加入檸檬酸清潔劑與內容器同時清洗污垢仍然無法洗淨時，請更換零件。

零件型號	PVH1045
------	---------

更換上蓋墊圈的方法

拆卸方式

1 請鬆開螺絲(3根)。

2 拆卸上蓋墊圈。

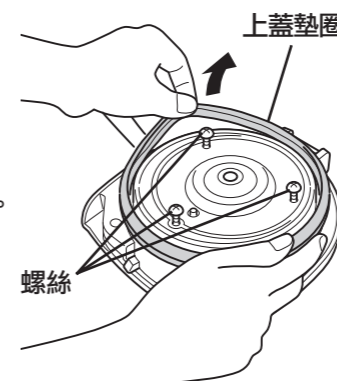

安裝方式

1 將新的上蓋墊圈確實嵌入在栓內蓋外圍。

上蓋墊圈的方向

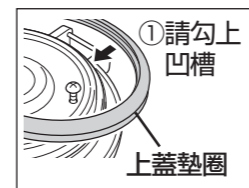

斷面圖

②請用手指沿著凹槽確實將上蓋墊圈嵌入。

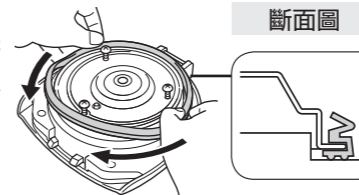

請確認是否有確實嵌入。



2 請確實將螺絲(3根)拴緊。

請注意

◆ 栓內蓋等零件，請勿從上蓋拆卸。避免蒸氣溢出或造成出水有問題。若墊圈脫落，請依照下圖正確安裝。

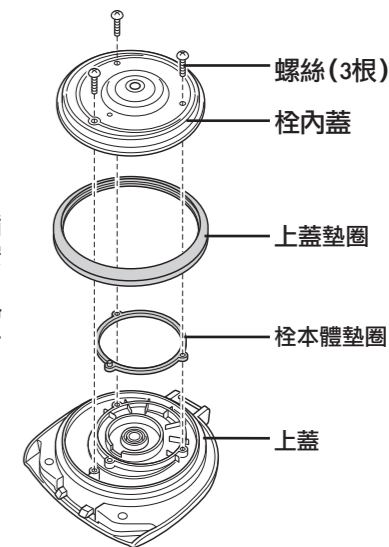

請務必按此插圖所示方向安裝。
(如果裝錯會讓熱水噴出而致受傷)

◆ 即使交換過上蓋墊圈仍然無法出水時，可能為其他墊圈或成形品已受損之情形。(若從外觀上看出圖示中(A)的凸起部已受損，請更換新的零件。)請至各虎牌服務處洽購。

