

# Stainless Steel Desk Mug

## Instructions

Thank you for purchasing a "TIGER" Stainless Steel Desk Mug.  
Please read the Instructions completely before use.  
Keep these Instructions for future reference.

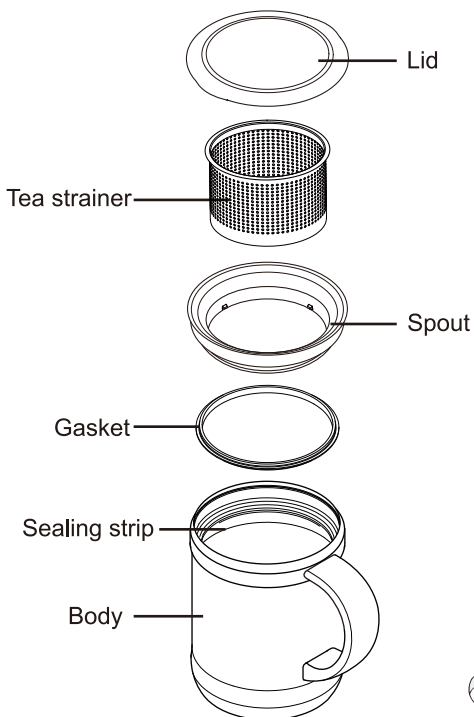

※ Before use, check that no parts are missing.

# Safety Precautions

## Important!

Keep out of reach of children.

Do not put dry ice or carbonated beverages in the product.

Do not store milk, dairy products, or certain fruit juices in the product.

Do not place the product near stoves, open flames, or other sources of extreme heat.

Do not heat the product in a microwave oven.

Do not fill the product above the maximum level shown below.

※ When the tea strainer is not attached to the body.

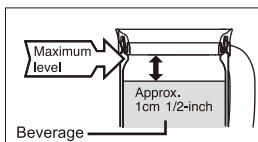

※ When the tea strainer is attached to the body.

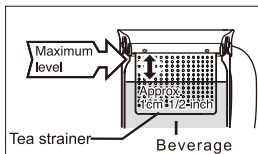

Be sure to set the lid in proper position.

Consume beverage within the day to prevent from spoiling.

Drink slowly when the product contains hot beverage.

Noncompliance to this instruction may result in scald or injury.

Do not use the product for any purposes other than keeping beverages warm or cold.

Do not knock over, drop or expose the product to excessive shocks.

Do not disassemble or attempt to repair the product by yourself.

Be sure to clean the product immediately specially after sports drink.

Do not store soups or beverages containing salt in the product.

Do not use chlorine-based bleaches or cleaner when cleaning the product.

Do not remove the protective sheet on the underside of the product.

Hold the handle firmly when you pick up and put down the product.

Do not use a dishwashers / dish dryers. This may cause rust.

# How to use

## 1 Remove the lid, spout, and tea strainer.

### First Time Use

- Refer to “First Time Use” to wash the product. → P.5
- Be sure to install the spout gasket properly.

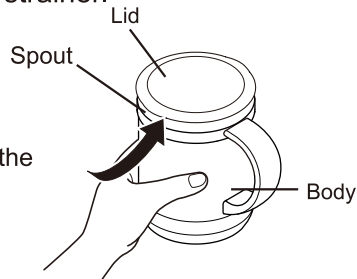

## 2 To keep your beverage warm longer, pour hot water into the product, and let it sit for one or two minutes to allow the inside of the product to heat. Pour out water after that.

## 3 Pour beverage or tea.

※ Tea leaves can be placed inside the body or tea strainer.

## 4 Attach the spout and tea strainer.

When you attach the tea strainer to the spout, align the strainer with the protrusion inside the spout, and press it down.

※ When you place tealeaves in the tea strainer for brewing, attach the tea strainer and spout to the body first.

### Caution

- When you use tiny tea leaves, they may leak out of the tea strainer.
- Be sure to click the four bayonets.

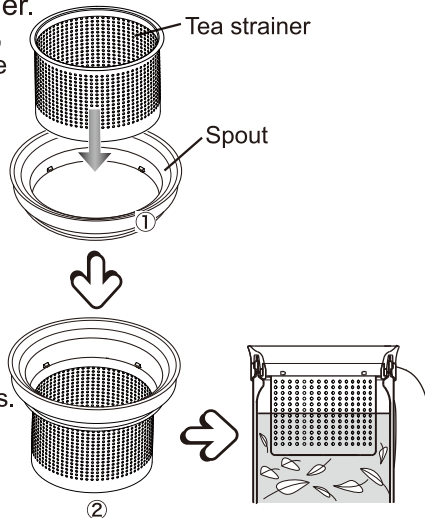

## 5 When you pour a beverage

Do not pour too much beverage as shown in the illustration.

### Caution

- Wipe off water on the body.
- Do not fill the product above the maximum level shown P1.

### Caution

- Be careful when you pour a beverage.  
Do not exceed the sealing strip when you pour a beverage.  
Do not pour too much beverage to avoid overflow which may cause burns.
- Slowly tighten the spout to minimize the gap between the body and spout.

## 6 Hold the handle while drinking.



## 7 Close the lid after you drink.

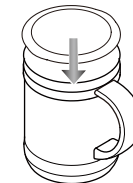

# How to clean

## First Time Use

Materials may produce a distinctive odor.  
In this case, wash the product in the order below.

- ① Store hot water in the body, and attach the spout and lid. → P.3-4
- ② Leave it for several minutes.
- ③ Pour out hot water and wash each part. → The following is the description.

- ◆ Clean after every use.
- ◆ Use mild kitchen detergent.
- ◆ Use a sponge or soft cloth.
- ◆ Be sure to clean the lid and gasket every use.



Body

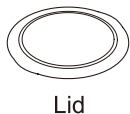

Lid

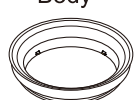

Spout



Tea strainer



Gasket

(→ P.6)

1. Wash the product with a sponge and water with detergents or warm water. Then rinse it with fresh water.
2. Dry water on the exterior of the body using a dry cloth.
3. Pour water out of the bottle and wait until it dries.



## Avoid a distinctive odor.

Before and after you store a sweet beverage or tea in the product, pour hot water and wash it several times to avoid a distinctive odor.

## Caution

- Do not immerse the body in water when washing it.
- Do not use the thinner, scouring powder, bleach, cleaning cloth, wire brush, and nylon brush.
- Do not use the dishwasher, dish dryer or boiling water.
- Attach the gasket of the spout firmly. → P.6
- When you do not use the product for a long period of time, wash it thoroughly and leave it open for drying.

## How to remove and install the gasket

When installation, set the gasket in the fixing groove firmly (Do not install the gasket in the wrong direction).

## Caution

Always attach the gasket correctly.

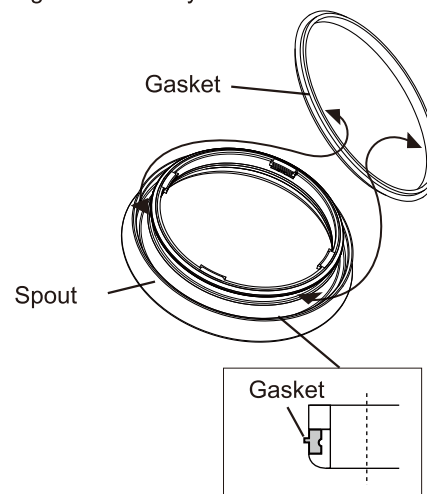

## How to clean a “reddish like rust spot” or “rough surface” appearing on the inner wall of the body

A “Reddish like rust spot” or “rough surface” results from the chemical reaction of minerals (such as calcium, magnesium, iron) in water. If stains become obviously visible, wash the product in the following order.

- ① Add hot water to citric acid (about 10g) and pour the mixture into the body.
  - ② Set aside for 2-3 hours and wash the product using a soft brush. Then rinse it with fresh water.
  - ③ Wait until completely dried.
- ※ For citric acid, go to Tiger's service desks or our authorized service centers.
  - ※ Do not use commercially available detergent for thermos bottles or vacuum flasks. Avoid damaging the gasket.

## Replacing and Purchasing Consumable Parts

The lid, spout and gaskets are consumable parts. Check once a year for damage/deterioration. For replacement parts, contact customer service.

## Before contact Customer Service

The utmost steps have been taken to ensure the quality of this product. Should the product be defective, however, contact Tiger Customer Service and provide the following information.

- ① Product name
- ② Model Number
- ③ Description of trouble (As detailed as possible)
- ④ Purchase date

Feel free to send any questions or comments about this product.

※ For the purpose of performance improvement, designs, specifications and parts shown in this publication are subject to change without notice.

## Specifications

Capacity		0.5liters/17oz
Heat retention	1 hour	Greater than 77°C • 170°F
Dimensions <sup>*1</sup>		11.4(W)×8.0(D)×15.0(H)cm
Weight <sup>*1</sup>		0.26kg
Materials		Inner flask / Outer container / Tea strainer : Stainless Steel

\* 1 Indicates an approximate value.

※ Heat retention has been calculated under the condition of adding hot water at 95°C ±1°C • 203°F ±2°F to the bottom edge of the sealing strip, and leaving it in a room temperature of 20°C ±2°C • 68°F ±4°F for 1 hour.

※ Capacity is actual volume that water can be stored up to the into the product when the spout is closed. It is not the "less capacity" referred in Safety Precautions



# TIGER

### TIGER CORPORATION

Head Office: 3-1 Hayamicho, Kadoma City, Osaka 571-8571, Japan  
URL : <http://www.tiger.jp/global.html>

## TIGER HANBAI (H.K.) CO., LTD.

Rm. 1006B, 10/FI., Join-in Hang Sing Centre, 71 - 75 Container Port Road, Kwai Chung, N.T.

Tel: (852) 2418-0912 Fax: (852) 2418-0911

## JAPAN TIGER CORPORATION OF U.S.A.

2730 Monterey Street, Suite 105 Torrance, CA 90503

Tel: (310) 787-1985 Fax: (310) 787-1986

EMAIL: [info@japantigercorp.com](mailto:info@japantigercorp.com)

# 辦公型不銹鋼真空保溫杯

## 使用說明書

感謝您購買本公司產品。請在使用前，務必詳讀使用說明書，以便正確使用並請妥善保管。

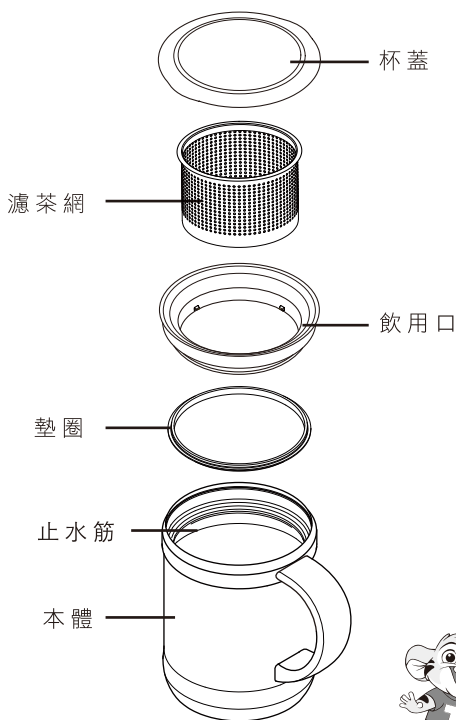

※ 使用前請確認各零件是否齊全。

## 消耗品更換・洽購

杯蓋、飲用口、栓體墊圈為消耗品。請以一年為基準做確認。

欲購買零件，請至原購買處或客戶服務中心洽詢。

## 產品諮詢相關

我們對於品質上的管理非常嚴謹，萬一產品上有出現瑕疵，請洽詢原購買處或虎牌客戶服務中心並提供以下信息。

- ① 產品名稱
- ② 產品型號
- ③ 產品狀況（請詳細描述）
- ④ 購買日

對於產品上有任何問題，歡迎洽詢。

※為了提升功能品質，本書記載的設計、規格及零件將有可能會不預期的變更。

## 規格

實際容量		0.5ℓ
保溫效力	1小時	77度以上
外形尺寸 *1		11.4(長)×8.0(寬)×15.0(高)cm
重量 *1		0.26kg
本體、濾茶網材質		SUS304 不銹鋼

\* 1表示大約的數值。

※保溫效力是指在室溫20度±2度的條件之下，將95度±1度的熱水倒入至止水條下緣，放置1小時後的水溫。

※實際容量為裝好飲水口時，可實際倒入至止水條下緣的容量。

並非是安全注意事項中所記載的「略少容量」。



# TIGER 虎牌

### TIGER CORPORATION

Head Office: 3-1 Hayamicho, Kadoma City, Osaka 571-8571, Japan

網址: <http://www.tiger-corporation.tw>

## 虎記股份有限公司

台南總公司：台南市702南區新樂路63號

TEL:06-265-5899 FAX:06-264-7707

台北分公司：台北市100中正區紹興北街3號2樓

TEL:02-2397-1179 FAX:02-2397-5737

台中分公司：台中市402南區忠明南路705號

TEL:04-2375-4627 FAX:04-2375-4502

日本虎牌服務專櫃：請洽全國各大百貨公司虎牌專櫃或台南總公司，

台北分公司，台中分公司

免費服務專線：0800-888-572

# 清洗方法

## 初次使用時

材料可能產生特有的氣味。  
此時請按照以下順序清洗。

- ①本體內裝入熱水，安裝飲用口，杯蓋。→P.3-4
- ②放置數分鐘。
- ③將熱水倒出，清洗各零件。→以下將說明

- ◆使用後，請務必於當日內清洗。
- ◆清潔劑請使用廚房用合成清潔劑(餐盤用、調理器具用)。
- ◆請使用海綿·布等柔軟的清洗用具。
- ◆為避免殘留異味，請經常清洗。



本體



杯蓋

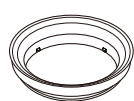

飲用口



濾茶網



墊圈

(→P.6)

1. 在倒入清洗劑的水或溫水中用海綿清洗，之後再用清水沖洗乾淨。
2. 本體外邊的水分，請用乾布擦乾。
3. 請將瓶內水分倒出，待其乾燥。

## 為避免產生異味

使用前或使用過含有糖分的飲料、茶葉後，請裝入熱水重複數次清洗的動作，便可防止異味產生，乾淨使用。

## 請注意

- 請不要浸泡本體清洗。
- 請不要使用稀釋劑、去污粉、漂白水、化學布、鋼絲刷及尼龍刷清洗。
- 請不要使用洗碗機、烘碗機或用水煮。
- 請確實安裝栓體的墊圈。 →P.6
- 長時間不使用時，請徹底洗淨髒汙，待其風乾。

## 墊圈的拆卸·安裝方法

安裝時，請確實將墊圈嵌入固定槽內。(請勿弄錯墊圈的安裝方向)

## 請注意

請務必正確安裝墊圈。

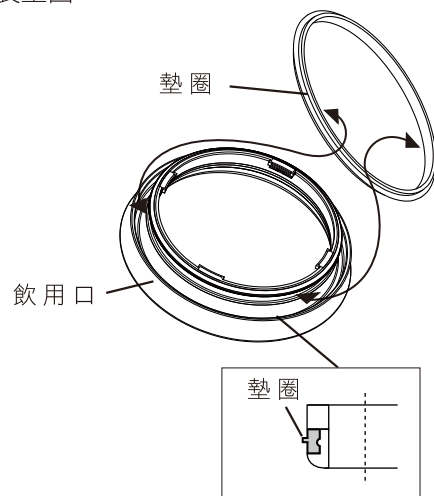

本體內壁附著「像鏽的紅色斑點」或「粗糙異物」的清洗方法

「像鏽的紅色斑點」或「粗糙異物」，是因為水中含有的礦物質(鈣、鎂、鐵等)作用所造成。如果污點變明顯，請按照以下順序清洗。

- ①將檸檬酸(約10g)加入熱水後倒入本體內部。
- ②放置2-3小時後使用軟刷洗淨，再用清水沖淨。
- ③待其完全乾燥。

※ 檸檬酸請到虎牌專櫃，或特約維修據點購買。

※ 請勿使用市售熱水瓶或保溫杯的清洗劑。以免弄壞墊圈。

# 使用方法

## 1 取下杯蓋、飲用口、濾茶網。

### 初次使用時

- 請參閱「初次使用時」清洗。 →P.5
- 確認飲用口墊圈是否確實安裝。

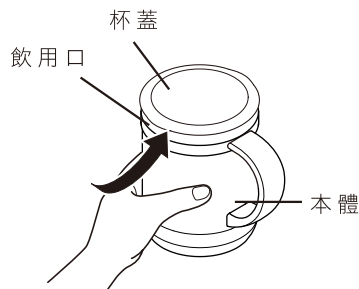

## 2 如果想提高保溫效力，請事先裝入少量熱水，預熱1~2分鐘。預熱後，請將水倒掉。

## 3 倒入飲料和茶。

※ 茶葉可放在本體裡，也可以放在濾網裡。

## 4 安裝飲用口和濾茶網。

濾茶網裝到飲用口時，請將濾茶網對準飲用口內側的凸部，然後往下按。

※ 茶葉裝入濾茶網浸泡時，請先將濾茶網和飲用口一起裝到本體上。

### 請注意

- 使用細小茶葉時，可能會從茶濾網中漏出。
- 確實將四個卡口都全部卡入。

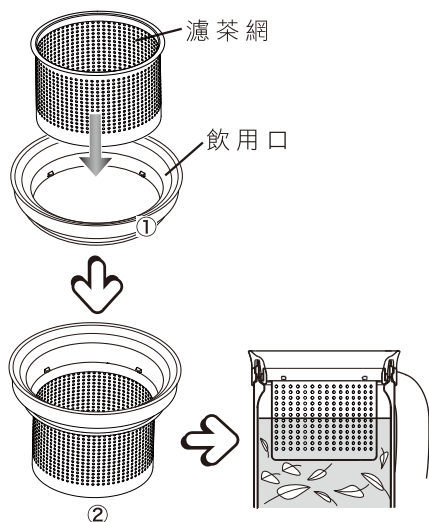

## 5 倒入飲料時。

如圖所示，請不要倒入過量的飲料。

### 請注意

將本體表面的水分擦拭乾淨。  
飲料量限裝入至圖示的位置。→P.1

### 請注意

- 倒入飲料時請注意。  
倒入飲料到低於止水筋的位置即可。  
請勿倒入過量飲料，以免飲料溢出，導致燙傷。
- 旋緊飲用口時請慢慢旋，使本體與飲用口蓋之間的縫隙變小。

## 6 握住把手飲用。



## 7 飲用完後蓋上杯蓋。



# 安全注意事項

為避免造成受傷或燙傷，請務必遵守以下內容。

請勿置放於幼兒易拿取的地方。

請勿裝入乾冰·碳酸飲料等。

請勿裝入牛乳·乳製飲料·果汁等。

請勿置放於瓦斯火爐及暖爐等，靠近火源附近及高溫環境。

請勿使用微波爐加熱。

飲料量限裝入至圖示的位置。

※ 濾茶網未裝到本體上。

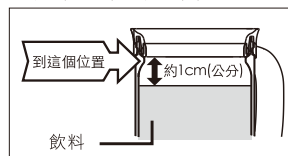

※ 濾茶網裝到本體上。

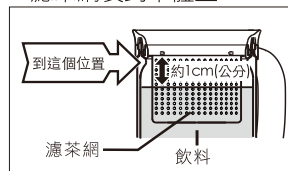

請確認杯蓋與飲用口是否確實安裝蓋緊。

為避免飲料腐敗，請於當日內飲用完畢。

放入熱飲時，請小心飲用。

為避免造成受傷或燙傷，請務必遵照使用說明書記載的方式使用。

請勿使用於保溫·保冷飲料以外之用途。

請勿翻倒、摔落地面或撞擊等給予強烈的衝擊。(可能造成保溫或保冷效能失效)

請勿自行解剖或修理。

若裝入運動飲料，飲用完畢後請盡速清洗。

請勿裝入味增湯或濃湯等含有鹽分的湯汁。

請勿使用鹽素系漂白劑。

請勿撕下本體底部黏貼的保護貼紙，及本體貼紙。

取放杯子時，請務必拿穩把手，避免傾斜，以免燙傷。

清洗後，請確實將水滴擦乾，使其保持完全乾燥。